

Heckla Cookstove

An attractive fireplace and an efficient oven that naturally integrates living with functionality and style. Heckla— the ultimate wood-fired cookstove was designed for both heating and baking by Vlastislav Vyborny from Romotop in the Czech Republic. Using ergonomic intelligence and pace-setting style savvy, the Heckla is created as an aesthetic technological product of the 21st century.

Cooking food on a wood burning fire in a cookstove gives food a natural taste. The baking/roasting compartment can reach temperatures up to 500°F. The thermometer enables cooking food to perfection. The Heckla comes with an oven rack, a solid tray rack, and a baking stone. Special spring handles enable ease of use and provide a compact look. There is a drawer for storage underneath.

Quality constructed with cooking in mind, the body is made of high-grade steel in a gray steel finish. The cladding is available in a variety of tile colors (shown on the opposite page in burnt orange tile and at top right in white tile), gray steel, sandstone, or natural stone (all shown at right). Top vent only.

Tested to Washington State fireplace environmental standards, and approved to UL 1482 standards in the United States and ULC S627 in Canada, the Heckla is highly efficient (78%) and clean-burning.



White Tile



Steel

Sandstone

Natural Stone

Technical Specifications		
Heat output range	14-38kBTU	4-11kW
Approx. heating area	1,600ft²	150m²
Flue size	6"	15cm
Weight	600-880lb	275-400kg
Dimensions: h/w/d	66/24/21"	167/60/53cm
Firebox height	29"	73cm
Oven height	15"	39cm

Heckla Outlines

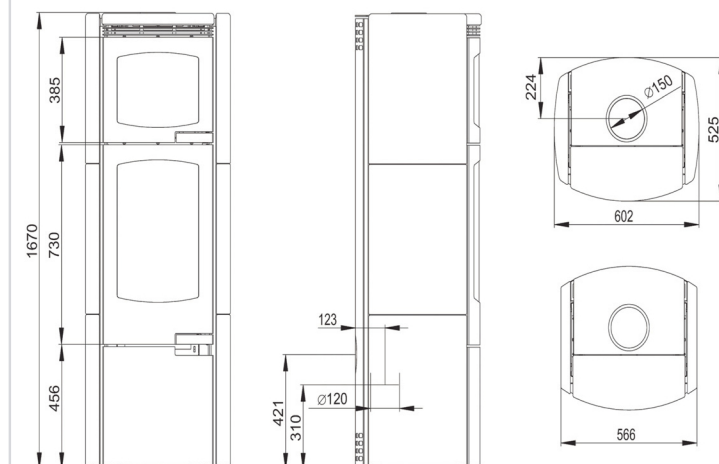

Obadiah's
800-968-8604

1660 Whalebone Dr. Kalispell MT 59901
www.woodstoves.net www.stove-parts.net

WITTUS
FIRE BY DESIGN