



CAST WOOD STOVES

QUADRA-FIRE
NOTHING BURNS LIKE A QUAD

QUADRA-FIRE®

PERFORMANCE FROM THE BEGINNING



In 1990, the U.S. Environmental Protection Agency (EPA) enacted stringent wood-burning regulations, crippling the more than 500 wood stove manufacturers around the country. But not Quadra-Fire®.

Two years of research and development later, founders Alan Trusler and Dan Henry unveiled their patented "Quad Burn" system. The technology produced powerful and efficient rolling flames so intense, it dawned the inception of the Quadra-Fire name.

WHY QUADRA-FIRE

For more than 30 years, Quadra-Fire has put performance and easy operation above all else. Today these ideals are vibrant and alive, blending our past with our present. Quadra-Fire products are proudly built to last by our members.

WHY WOOD

IT'S RENEWABLE - Using renewable energy sources is more important than ever and wood is 100 percent renewable. When you burn wood, you are also completing the last step of the natural carbon cycle of trees, resulting in a zero net carbon impact on the environment.

IT'S COST-EFFECTIVE - Heating with wood costs less than heating with electricity, liquid propane or heating oil, especially if you harvest wood yourself.

As the fire ignites, it remains clear:
NOTHING BURNS LIKE A QUAD.



COVER: EXPLORER II IN PORCELAIN MAHOGANY

QUADRA-FIRE CAST WOOD STOVES

Powerful and efficient, Quadra-Fire cast iron wood stoves are the most durable products in the category. They're built to last with a solid steel welded firebox and range of finish colors.

PERFORMANCE

- Get maximum heat and a clean burn, with the Quadra-Fire Four-Point Burn System delivering performance that you can see

EASY OPERATION

- Eliminate the hassle and save time with the Automatic Combustion Control (ACC): simply load the wood, light the fire and walk away
- Quick and easy cleaning with the Quadra-Fire Ash Removal System (ARS)



EXCLUSIVE TECHNOLOGIES Innovative technology is at work in every Quadra-Fire. These advancements make it possible to burn wood more effectively, efficiently, and with more control.

FOUR-POINT BURN SYSTEM

The patented Quadra-Fire Four-Point Burn System produces intense rolling flames. Four combustion cycles extend the heat, enhance the fire and increase efficiency for long-lasting, proven performance.

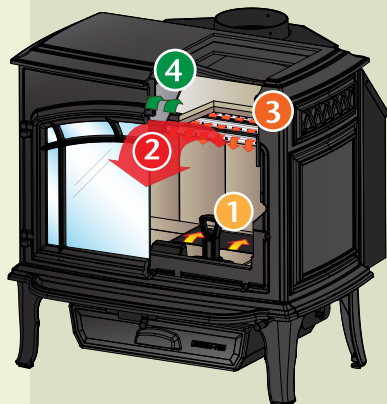

1. PRECISION START-UP

Airflow quickly routes to the heart of the fire.

2. SECONDARY BURN ZONE

Air movement helps create rolling flames and keeps the glass clean.

3. TERTIARY BURN ZONE

Superheated air ignites flammable gases rising from the wood.

4. QUATERNARY BURN ZONE Remaining impurities are burned above the baffle before exiting up the chimney.

AUTOMATIC COMBUSTION CONTROL

Automatic Combustion Control (ACC) is an advanced heat-management technology from Quadra-Fire. ACC feeds the fire with air when it's needed most—for precision start-up and consistent, extended burns.

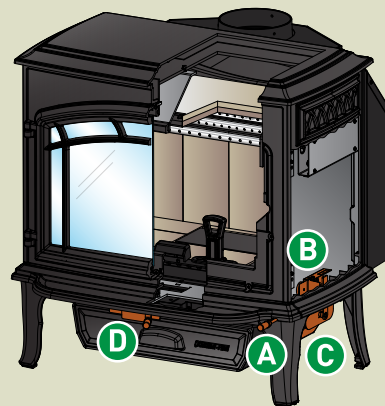

A. ACTIVATION CONTROL KNOB

Push back and pull forward to activate startup airflow.

B. ACC AIR INLET

Controls startup airflow to build the fire.

C. ACC TIMER

Opens ACC air inlet during startup for approximately 20 minutes.

D. BURN RATE CONTROL Controls the airflow feeding the fire, also controls your comfort.

EXPLORER III



Large Ash Drawer



Top Loading

EXPLORER III SHOWN IN CLASSIC BLACK

Peak
BTU/Hr Output¹
70,300

Heating Capacity²
1,500-4,000
sq. ft.

Max. Burn Time³
15 hrs

Efficiency⁴
74.4%

Emissions
2.0 g/hr

Firebox
3.0 cu. ft.

Recommended
Log Length
22"

Viewing Area
286 sq. in.

Actual Weight
545 lbs



EXPLORER III » PORCELAIN MAHOGANY

PORCELAIN BLACK

PORCELAIN FROST

PORCELAIN DARK BLUE

CLASSIC BLACK

EXPLORER II



Large Ash drawer

EXPLORER II SHOWN IN PORCELAIN BLACK

Peak
BTU/Hr Output¹
61,000

Heating Capacity²
1,300-3,400
sq. ft.

Max. Burn Time³
12 hrs

Efficiency⁶
78.3%

Emissions
2.2 g/hr

Firebox
2.4 cu. ft.

Recommended
Log Length
20"

Viewing Area
234 sq. in.

Actual Weight
460 lbs



EXPLORER II » PORCELAIN MAHOGANY

PORCELAIN BLACK

PORCELAIN DARK BLUE

CLASSIC BLACK

YOSEMITE



Side Loading

YOSEMITE SHOWN IN PORCELAIN MAHOGANY

Peak
BTU/Hr Output¹
47,800

Heating Capacity²
800-2,200

Max. Burn Time³
7 hrs

Efficiency⁴
79.3%

Emissions
2.7 g/hr

Firebox
1.45 cu. ft.

Recommended
Log Length
18"

Viewing Area
132 sq. in.

Actual Weight
365 lbs



YOSEMITE » CLASSIC BLACK



PORCELAIN MAHOGANY

ACCESSORIES



FIRESCREEN
EXPLORER III / EXPLORER II / YOSEMITE



FAN KIT
EXPLORER III / EXPLORER II / YOSEMITE

QUADRA-FIRE[®]

STOVE COMPARISON

EXPLORER III	EXPLORER II	YOSEMITE
<p>PEAK BTU/HOUR OUTPUT¹ » 70,300</p>	<p>PEAK BTU/HOUR OUTPUT¹ » 61,000</p>	<p>PEAK BTU/HOUR OUTPUT¹ » 47,800</p>
<p>HEATING CAPACITY² » 1,500 - 4,000 sq. ft.</p>	<p>HEATING CAPACITY² » 1,300 - 3,400 sq. ft.</p>	<p>HEATING CAPACITY² » 800 - 2,200 sq. ft.</p>
<p>MAXIMUM BURN TIME³ » 15 hours</p>	<p>MAXIMUM BURN TIME³ » 12 hours</p>	<p>MAXIMUM BURN TIME³ » 7 hours</p>
<p>EFFICIENCY⁶ » 74.4%</p>	<p>EFFICIENCY⁶ » 78.3%</p>	<p>EFFICIENCY⁶ » 79.3%</p>
<p>EMISSIONS » 2.0 g/hr</p>	<p>EMISSIONS » 2.2 g/hr</p>	<p>EMISSIONS » 2.7 g/hr</p>
<p>FIREBOX CAPACITY » 3.0 cu. ft.</p>	<p>FIREBOX CAPACITY » 2.4 cu. ft.</p>	<p>FIREBOX CAPACITY » 1.45 cu. ft.</p>
<p>RECOMMENDED LOG LENGTH » 22"</p>	<p>RECOMMENDED LOG LENGTH » 20"</p>	<p>RECOMMENDED LOG LENGTH » 18"</p>
<p>VIEWING AREA » 286 sq. in.</p>	<p>VIEWING AREA » 234 sq. in.</p>	<p>VIEWING AREA » 132 sq. in.</p>
<p>ACTUAL WEIGHT » 545 lbs</p>	<p>ACTUAL WEIGHT » 460 lbs</p>	<p>ACTUAL WEIGHT » 365 lbs</p>
<p>TECHNOLOGIES » ACC, Four-Point Burn</p>	<p>TECHNOLOGIES » ACC, Four-Point Burn</p>	<p>TECHNOLOGIES » Four-Point Burn</p>

CLEARANCES TO COMBUSTIBLES

STEP TOP SERIES		Full Vertical OR Horizontal with Minimum 2 Feet Vertical Off Stove Top						
		A	B	C	D	E	F	G
Explorer III	Single Wall Pipe	10-1/2"	7"	27"	12"	7"	18"	52-1/2"
	Double Wall Pipe	9-1/2"	6"	27"	12"	5"	16"	52-1/2"
Explorer II	Single Wall Pipe	10-1/2"	6-1/2"	20-1/4"	6-1/2"	7"	17-1/4"	55"
	Double Wall Pipe	9-3/8"	5-3/8"	20-1/4"	6-1/2"	4-1/2"	14-3/4"	55"
Yosemite ⁴	Single Wall Pipe	15-1/2"	9"	22-1/2"	10"	14"	23-1/2"	59"
	Double Wall Pipe -	13-1/2"	7"	22-1/2"	10"	7"	14-1/2"	59"

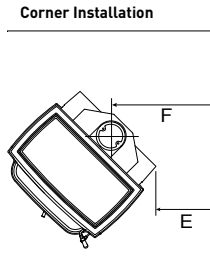
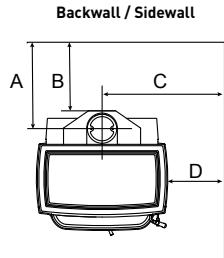

Stove to Ceiling Clearance

*Follow pipe manufacturer's clearances as required

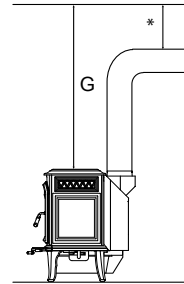

HEARTH PROTECTION

	A	B	C	D	E	F	G	H	I	J	K
Explorer III	8"	16"	35-3/8"	39-3/8"	49-3/4"	19-1/8"	36-1/4"	60-7/8"	47-1/4"	33-3/4"	57-1/4"
Explorer II	8"	16"	35-1/4"	35-5/8"	48"	19-1/4"	34-3/8"	58-1/4"	45-1/2"	31-7/8"	54-5/8"
Yosemite ⁴	8"	16"	35-1/4"	36"	51"	17-1/8"	37"	62-1/4"	42"	29-7/8"	50-7/8"

Standard Dimensions

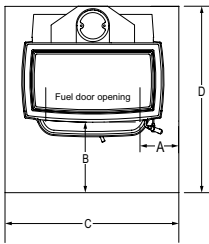

Note: Use Type II hearthpads.

Corner Dimensions w/Single Wall Pipe

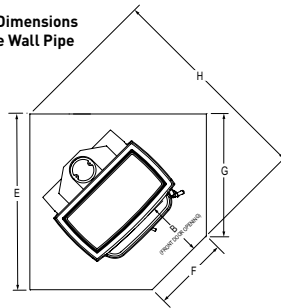

Corner Dimensions w/Double Wall Pipe

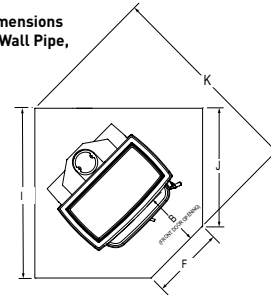

QUADRA-FIRE®

NOTHING BURNS LIKE A QUAD

www.quadrafire.com | 800-926-4356

Available From:

Limited Lifetime Warranty⁵

The strongest in the industry, Quadra-Fire provides a limited lifetime warranty on the most important aspects: firebox and heat exchanger.

- facebook.com/QuadraFire
- twitter.com/QuadraFire
- youtube.com/QuadraFirePower

1: BTU: 1st hour output uses high burn efficiency number. BTU will vary depending on the type of fuel used and moisture content of the fuel. **2:** Heating capacity (in square feet) is a guideline only and may differ due to climate, building construction and condition, amount and quality of insulation, location of the heater, and air movement in the room. **3:** Actual burn times will vary based on how the appliance is operated, load size, moisture content and type of wood used, chimney height and installation **4:** For clearances and hearth pad protection information for side-loading Yosemite, visit <http://www.quadrafire.com/Products/Yosemite-Wood-Stove>. **5:** For full warranty details go to www.quadrafire.com. **6:** Weighted average LHV (Low Heating Value) efficiency.

IMPORTANT - READ BEFORE YOU INSTALL! - Refer to the Owner/Installation Manual for complete clearance requirements and specifications. The images and descriptions in this brochure are provided to assist you in product selection only.

Quadra-Fire is a registered trademark of Hearth & Home Technologies. Product specifications and pricing subject to change without notice.

Fireplace, stove and insert surfaces get extremely HOT and can cause burns if touched. Keep a safe distance away. To learn more visit www.quadrafire.com/fireplacesafety.