

2.1 DIMENSIONS

2.1.1 1101 DIMENSIONS (COMPLETE WITH FLASHING)

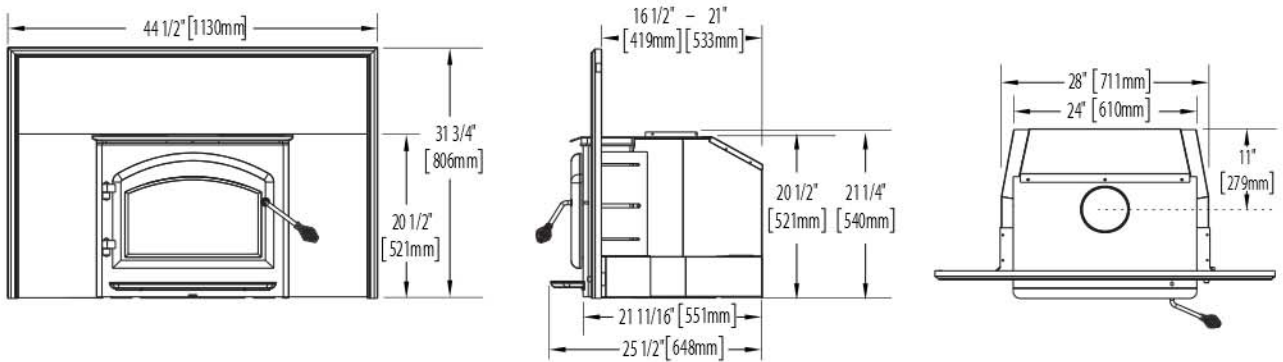

2.1.2 1402 DIMENSIONS (COMPLETE WITH FLASHING)

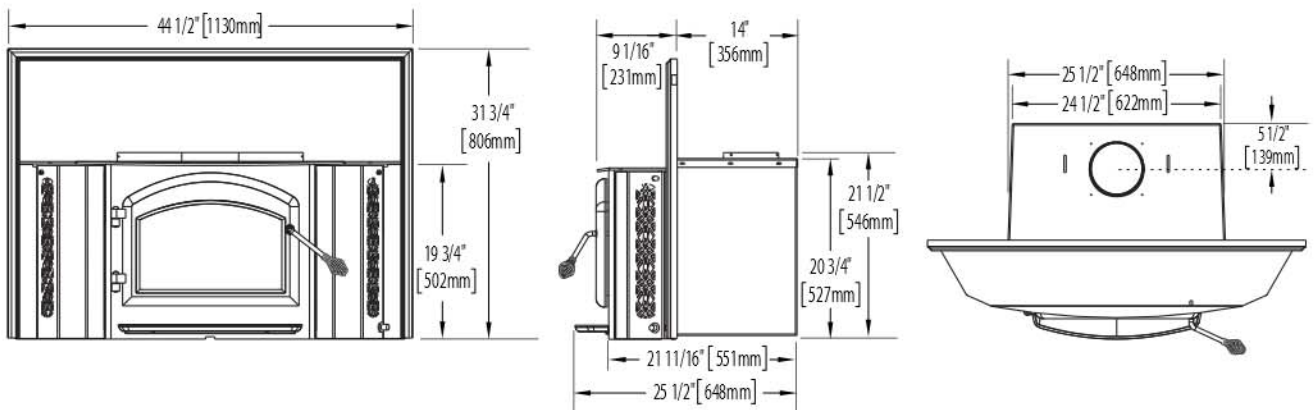

2.2 SPECIFICATIONS

Specifications	1101	1402
CHAMBER (D.W.H)	13 1/2x18x12" (343mmx-457mmx305mm)	18x18x12" (457mmx457mmx-305mm)
CAPACITY	1.7 ft ³	2.25 ft ³
APPROX. AREA HEATED**	600-1600 ft ²	800-2000 ft ²
MAXIMUM HEAT OUTPUT***	55,000 BTU/Hr	70,000 BTU/Hr
HEAT OUTPUT*	11,700 - 42,200 BTU/Hr	11,400 - 41,300 BTU/Hr
DURATION LOW FIRE**	7 Hours	9 Hours
WEIGHT W/O BRICKS	185 lbs (84kg)	250 lbs (113kg)
WEIGHT OF BRICKS	110 lbs (50kg)	145 lbs (66kg)
IDEAL FUEL SIZE	12" (305mm)	16" (406mm)
MINIMUM DEPTH	16 1/2" (419mm)	14" (356mm)
MAXIMUM DEPTH	21" (533mm)	14" (356mm)

* As tested using test method 28

** Figures will vary considerably with individual conditions.

***Wolf Steel Ltd. estimated realistic BTU/hr with hardwood logs and regular refueling.