



For today's highly competitive new construction marketplace, there is no better choice than the BC and BR models from Superior®.

The BR is a clean-face radiant fireplace with no exposed louvers, permitting surround material to be installed flush against the front opening.

The BC is a practical heat-circulating fireplace with an optional fan system that increases warm air distribution.



BC-42 base model



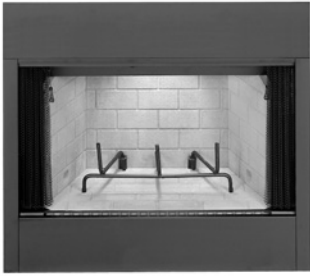

BR-36



BC-42

STANDARD FEATURES

Choice of radiant (clean face) or louvered (heat-circulating) models

Two opening sizes: 36 and 41

Uses economical Security® FTF8 double wall, air cooled chimney system

Brick lined firebox for look of real masonry

Durable powder coat finish

Standard fuel grate, damper and mesh firescreens

Built-in outside air control mechanism

Gas connection knockouts on both sides of firebox

20-year limited warranty

OPTIONAL ACCESSORIES

Decorative glass doors in a variety of handsome styles and finishes

Outside combustion air kit

Forced air kit (BC models)

BR/BC-36 DIMENSIONS

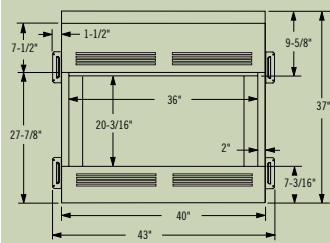

Front View (BC-36 shown)

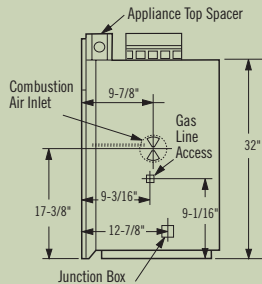

Right Side View

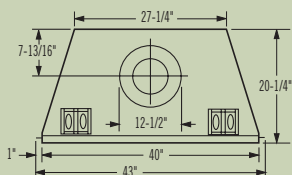

Top View

INSIDE HEARTH

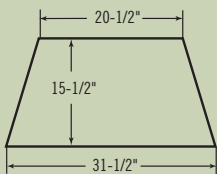

BR/BC-42 DIMENSIONS

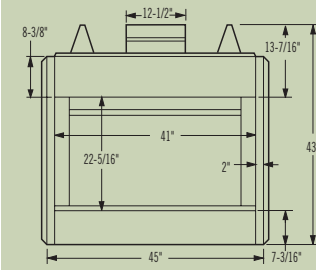

Front View (BR-42 shown)

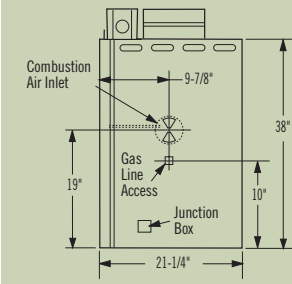

Right Side View

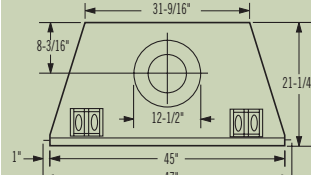

Top View

INSIDE HEARTH

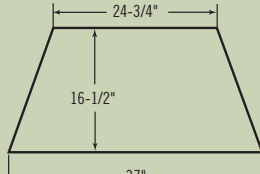

FRAMING DIMENSIONS

Model	Width	Height	Depth
BC-36	42-1/4"	37-1/2"	20-5/8"
BC-42	46-1/4"	43-1/2"	21-5/8"
BR-36	42-1/4"	37-1/2"	20-5/8"
BR-42	46-1/4"	43-1/2"	21-5/8"

ON THE COVER: BR-36 shown with optional 36ABF-BB bi-fold glass doors

IMPORTANT NOTES:

As with any heating appliance, fireplace or stove, this appliance is extremely hot during operation. Read and understand all operating instructions before using this appliance. For further information, consult your dealer.

Actual performance may vary depending upon home design and insulation, ceiling heights, climate, condition and type of wood used, appliance location, burn rate, accessories chosen, chimney installation and how the appliance is operated.

Diagrams, illustrations and photographs are not to scale - consult installation instructions. Product designs, materials, dimensions, specifications, colors and prices are subject to change or discontinuance without notice.

Built to UL127/ULCS610 standards.

Agency listings:
Warnock Hersey 42" (J990258653-231)
Omni Test Lab - 36" (116-F-35-2)

Distributed by:



©Lennox Industries Inc. 2011
Visit us at www.Lennox.com, or contact us at 1-800-9-LENNOX.



100% recycled