

DAVE LENNOX
signature
COLLECTION

EPA-CERTIFIED WOOD-BURNING FIREPLACES



LENNOX

HEARTH PRODUCTS

CLASSIC COMFORT
AND CLEAN CHOICES



AIR QUALITY IS NO LONGER A SACRIFICE

■ Building on a strong heritage of innovative design and high-performing functionality, Lennox Hearth Products offers a full line of EPA-certified wood-burning fireplaces that are as beautiful as they are practical. With a wide range of options to suit every taste and style—from traditional, elegant designs to sleek, modern choices—a Lennox fireplace makes a striking addition to any setting.

As a leader in the development of clean-burning technologies, Lennox Hearth Products has dedicated the past decade to engineering this line of EPA-certified fireplaces. Today, we are proud to offer homeowners the comfort of a warm hearth with the assurance of responsible burning. ■



THE DETAILS OF EPA CERTIFICATION

The U.S. Environmental Protection Agency sets standards for air quality—including limits on the amount of particulate matter (microscopic particles) emitted by fireplaces. In order to receive EPA certification, a wood-burning fireplace must produce less than 7.5 grams of particulate per hour.





MONTECITO™—THE PERFECT PERFORMER

■ The Montecito™ fireplace delivers generous, relaxing warmth, transforming living areas into inviting gathering spaces for family and friends. And because the Montecito comes standard with a variable-speed blower to boost heat output, there's no need to run a full-home heating system all the time—helping you reduce energy costs. All this and the treasured look of a traditional fireplace make the Montecito a perfect choice. ■



Montecito™ shown with brushed-nickel door and façade



Montecito shown with black door and façade

STANDARD FEATURES

EPA-certified and Washington State-approved 3.7 gr/hr emissions

2.0-cu.-ft. firebox with 19" log capacity provides ample space for a dramatic fire

Compact size is ideal for smaller spaces

Textured refractory-lined firebox recreates a traditional masonry fireplace appearance

Single-door design provides an exceptional view of the fire

Decorative andirons add to the sophisticated look and feel

Up to 55,000 BTU/hr heat output

Burn time up to 8 hours and heating capacity up to 1,500 sq. ft.*

Heat-activated variable-speed blower offers energy-efficient heat distribution

A single lever controls heat output, burn rate and an air boost for faster ignition

Air wash system helps keep window clean for a beautiful view of the fire

Utilizes 6" Secure Temp™ ASHT+ Chimney

OPTIONAL ACCESSORIES

Black, brushed-nickel and hammered-steel doors and façades

Rigid firescreen

Double-duct gravity kit

Masonry installation with TUBINOX™ rigid stainless steel liner

**Actual performance may vary, depending upon home design and insulation, ceiling height, climate, condition and type of wood used, appliance location, burn rate, accessories chosen, chimney installation and how the appliance is operated.*



MONTECITO ESTATE™ —BIG, BOLD AND BEAUTIFUL

■ The Montecito Estate™ is a powerful, yet stunning heater. With a 4.0-cu.-ft. firebox and 30" log capacity, it is one of the largest EPA-certified fireplaces available. The double-door design allows for an impressive view of the fire, and advanced controls make the Montecito Estate easy to light and operate. For greater heat output, turn on the standard blower. A wide selection of striking doors and façades allows you to achieve a look that reflects your personal style and taste. ■



Montecito Estate™ shown with hammered-steel doors and façade



Montecito Estate shown with brushed-nickel doors and façade

STANDARD FEATURES

EPA-certified 7.4 gr/hr emissions

Textured refractory-lined firebox recreates a traditional masonry fireplace appearance

Up to 80,000 BTU/hr heat output delivers clean and powerful heating

Burn time up to 8 hours and heating capacity up to 2,500 sq. ft.*

Heat-activated variable-speed blower and time-delayed heat distribution provide even comfort

Time-delayed Air Boost system offers fast and easy ignition

Air wash system helps keep window clean for a beautiful view of the fire

Decorative andirons add to the sophisticated look and feel

Utilizes 7" Secure Temp™ GX Chimney

OPTIONAL ACCESSORIES

Black, brushed-nickel and hammered-steel doors and façades

Rigid firescreen

Double-duct gravity kit

Masonry installation with TUBINOX™ rigid stainless steel liner

**Actual performance may vary, depending upon home design and insulation, ceiling height, climate, condition and type of wood used, appliance location, burn rate, accessories chosen, chimney installation and how the appliance is operated.*



LADERA™ —A MIGHTY FIREPLACE

■ The Ladera™ boasts a clean-face design, expansive viewing area and elegant refractories to create a stunning addition to any living space. The firebox accepts logs up to 18" to deliver large, entertaining flames, long burn times and additional warmth. And don't be fooled by its size—this contemporary marvel is small but powerful. Featuring a standard blower for better heat circulation, the Ladera's compact design makes it an ideal choice for both new construction and remodeling. ■



Ladera™ shown



Ladera shown with optional cast-iron surround and decorative keystone

STANDARD FEATURES

EPA-certified 4.8 gr/hr emissions

Airtight combustion chamber delivers maximum efficiency

All-in-one Double-Air Combustion control includes air boost for faster wood ignition and main air control for variable heat output

Clean-face, louverless design keeps the focus on the beauty of the fire

Expansive glass area allows for unobstructed views of the hearth

Textured refractory-lined firebox recreates a traditional masonry appearance

Efficient air wash system keeps the glass clean

Ceramic glass promotes optimum heat transfer and safety*

Outside air kit connection helps optimize efficiency

Convenient factory-installed fan included

Choice of black or brushed-nickel door

Utilizes 6" Secure Temp™ ASHT+ Chimney

OPTIONAL ACCESSORIES

Cast-iron surround kit and optional decorative keystone

Double-duct gravity kit

Rigid firescreen

Masonry installation with TUBINOX™ rigid stainless steel liner

6" to 7" Secure Temp™ ASHT increaser

**Actual performance may vary, depending upon home design and insulation, ceiling height, climate, condition and type of wood used, appliance location, burn rate, accessories chosen, chimney installation and how the appliance is operated.*



BRENTWOOD™—THE DEFINITION OF COZY

■ With advanced combustion and heat-circulating features, the Brentwood fireplace offers unsurpassed warmth and comfort. Its simple and timeless design, featuring an unobstructed cast-iron door and 6–8 hours of burn time, means the view will always be lovely and entertaining. With a variety of convenient features and design options, the Brentwood is sure to be the ideal addition to any cozy living space. ■



Brentwood™ shown with clean-face panel kit and gravity kit ducts



Brentwood shown

STANDARD FEATURES

EPA-certified and Washington State-approved 3.7gr/hr emissions

Textured refractory-lined firebox recreates the classic masonry appearance

European-style cast-iron single door offers an unobstructed view of the fire; available in two finishes

Up to 55,000 BTU/hr* effectively heats up to 1,500 sq. ft.* (with optional blower)

Airtight combustion chamber delivers maximum efficiency to ensure steady home heating

All-in-one Double-Air Combustion features two controls that allow you to customize home heating

Efficient air wash system keeps the glass clean, reducing the hassle of maintenance

Heat-resistant handle stays cool to the touch

Burn time is approximately 6–8 hours for long-lasting comfort

Utilizes 6" Secure Temp™ ASHT+ Chimney

OPTIONAL ACCESSORIES

Blower

Clean-face panel kit (requires use of double-duct gravity kit)

Double-duct gravity kit

Optional brushed-nickel door

Rigid firescreen

Masonry installation with TUBINOX™ rigid stainless steel liner

**Actual performance may vary, depending upon home design and insulation, ceiling height, climate, condition and type of wood used, appliance location, burn rate, accessories chosen, chimney installation and how the appliance is operated.*



BRENTWOOD™ LV—A STUDY IN SOPHISTICATION

■ Providing contemporary elegance and style, the Brentwood™ LV presents unobstructed views of the fire for the ultimate hearth experience. Its sleek, clean-face design option and modern, smooth, refractory-lined firebox add a touch of sophisticated class to any room. And it's as efficient as it is beautiful. The Brentwood LV features an airtight combustion chamber for maximum wood-burning efficiency, and an all-in-one control system allows for faster ignition while helping manage wood consumption. Relax in superior warmth while taking in the beauty. ■



Brentwood™ LV shown with clean-face panel kit installed



Brentwood LV shown with louvers

STANDARD FEATURES

Zero clearance to combustibles

Meets EPA II and Washington State emissions requirements (3.7g/hr)

55,000 BTU/hr heat output*

86.6% efficiency*

Airtight combustion chamber delivers maximum efficiency

All-in-one Double-Air Combustion Control includes air boost for faster wood ignition and main air control for variable heat output

Ceramic glass for added safety and optimum heat transfer

Fully insulated on top, sides and bottom

Efficient air wash system keeps glass clean

Knock-out sides and back for straightforward connection to optional forced-air system

Single-door design provides an unobstructed view of the fire

Heat-resistant door handle stays cool to the touch

Backed by the Good Housekeeping Seal

Smooth refractory-lined firebox fashions a modern appearance

Factory-installed 175-CFM blower with easy access for simple field service

OPTIONAL ACCESSORIES

Choice between clean-face panel** option for a contemporary design or elegant louvers for a more traditional look

Gravity air distribution kit

Forced-air kit

**Square-foot heating capacities are approximations only. Actual performance may vary depending upon home design and insulation, ceiling heights, climate condition and type of wood used, appliance location, burn rate, accessories chosen, chimney installation and how the appliance is operated.*

***Requires gravity air distribution kit installation.*



VILLA VISTA™—COMMANDING PRESENCE AND PERSONALITY

■ An inspirational balance of form and function, the Villa Vista fireplace is an ideal choice for large spaces, heating up to 2,500 sq. ft.* with high-efficiency catalytic technology. Its tall and expansive size features a single door that provides an unobstructed viewing area, while premium accessories complement its impressive stature. Choose from a selection of cast-iron door finishes and decorative louver designs to make the Villa Vista distinctly yours. ■



Villa Vista™ shown with clean-face panel kit (required gravity kit ducts not shown)



Villa Vista shown with optional gold door and Del Sol louvers

STANDARD FEATURES

EPA-certified 4.1 gr/hr emissions

European-style cast-iron single door provides a tall opening for a panoramic view of the fire

Ash pan is standard for easy cleaning

Ceramic glass for optimum heat transfer

Efficient air wash system keeps viewing glass clean

Choice of five distinctive louver designs

Choice of black, brushed-nickel or 24K gold-plated door

Cast-iron log retainer gives an upscale touch

Utilizes 7" Secure Temp™ ASHT+ Chimney

OPTIONAL ACCESSORIES

Optional blower circulates heat in large spaces or multiple rooms up to 2,500 sq. ft.*

Clean-face panel kit (requires use of double-duct gravity kit)

Double-duct gravity kit

Rigid firescreen

Masonry installation with TUBINOX™ rigid stainless steel liner

**Actual performance may vary, depending upon home design and insulation, ceiling height, climate, condition and type of wood used, appliance location, burn rate, accessories chosen, chimney installation and how the appliance is operated.*

Fireplace Size: What is Right for Your Home?

Heat output is related to the capacity of the firebox.

Larger fireplaces burn longer and will heat larger areas when fully loaded.

| MODEL | FIREBOX CAPACITY | APPROXIMATE HEATING AREA | BTU/hr |
|-------------------|------------------|--------------------------|--------|
| Ladera™ | 2.0 cu. ft. | 1,500 sq. ft. | 50,000 |
| Brentwood™ | 2.0 cu. ft. | 1,500 sq. ft. | 55,000 |
| Brentwood LV | 2.0 cu. ft. | 1,500 sq. ft. | 55,000 |
| Montecito™ | 2.0 cu. ft. | 1,500 sq. ft. | 55,000 |
| Villa Vista™ | 3.6 cu. ft. | 2,500 sq. ft. | 70,000 |
| Montecito Estate™ | 4.0 cu. ft. | 2,500 sq. ft. | 80,000 |

How Much Area Will a Fireplace Actually Heat?

This depends on a number of factors, including the design of your home and the location of the EPA-certified fireplace. The construction and energy efficiency of your home is also a critical factor.

Geographic conditions, including outside temperature and altitude, will have an effect on the heating ability of your fireplace.

A good strategy is to consider your EPA-certified fireplace as a zone heater. By heating the family areas of the home (living room, family room, kitchen, and dining area), you can turn down the thermostat and reduce your total energy consumption.

Is it a Good Idea to Buy a Larger Fireplace to Provide Heat in the Event of a Power Failure?

You should not buy an oversized EPA wood-burning fireplace. Here's why:

An oversized fireplace may overheat the family living area, particularly during the early and later parts of the heating season when outside temperatures are moderate.

When this occurs, people respond by burning smaller fires in their large-capacity fireplaces. This will drastically shorten the burn time and may result in the fireplace not burning hot enough to burn "clean," resulting in visible smoke and increased particulate emissions.

We suggest that your fireplace is correctly sized for your everyday needs, and that it is fully loaded for longer burn times and better performance.



Styling: Three Choices

We offer three distinct designs of EPA-certified fireplaces: louvered, façade and louverless—so that you can pick the style that best meets your needs.

Louvered: The Brentwood™ and Villa Vista™ are louvered fireplaces. Their upper and lower louvers provide for efficient circulation of heated room air, either by natural convection or by adding our optional blower.

If you desire, a clean-face kit option can be paired with our gravity kit to wall-mount two heat outlets up to 10' away from the fireplace. When the gravity kit is installed, non-combustible materials may be installed to the top of the fireplace door.

Façade: The Montecito™ and Montecito Estate™ have decorative façades in several finishes. The façades minimize the appearance of the circulation openings in the face of the fireplace. Our façade models include standard blowers to assist with efficient heat circulation.

Louverless: The Ladera's™ design features small air circulation slots located above and below the fireplace door. This design easily allows non-combustible facings to cover much of the fireplace front for a more traditional masonry appearance. The Ladera includes a standard blower.

Clean-Burning Technology

Lennox offers both non-catalytic and catalytic EPA-certified fireplaces.

Non-catalytic fireplaces mix secondary air drawn from the room and mix this air at the top of the firebox for a "secondary" burn. You will be treated to a beautiful fire with flames floating and burning above the logs.

Catalytic fireplaces pass fuel-rich gases through a ceramic catalyst that initiates a secondary burn. Catalytic designs display a more traditional-looking fire and require the user to open a bypass damper when lighting or refueling the fireplace. For those serious about heating with wood, our catalytic Villa Vista provides the most control of your heat output.

Chimney Pipe

All Lennox EPA-certified fireplaces are listed for use with either Security™ Secure Temp™ ASHT+ insulated chimneys or Security air-cooled chimney systems. For optimal performance, we recommend the use of insulated chimney systems, especially in colder-weather climates.

Why Do We Recommend the Use of Insulated Venting?

The chimney system creates the draft that lets your fireplace work efficiently, and a warmer chimney makes a fireplace easier to light, less likely to smoke and more likely to perform well in all temperatures and conditions. Security's solid-packed insulation maintains increased flue gas temperatures to achieve the maximum benefits of a warmer chimney. Thus, years of experience have shown that air-restricted designs, like those of wood-burning stoves and EPA-certified wood-burning fireplaces, demonstrate improved performance and durability when installed with insulated chimney systems such as Secure Temp ASHT+.

Warranty

All Lennox EPA-certified fireplaces feature a limited lifetime warranty for your peace of mind.

Burn Smart™

Lennox EPA-certified fireplaces are included in our Burn Smart™ collection of energy-efficient products that conform to third-party "green" standards. These standards include LEED (Leadership in Energy and Environmental Design), NAHB (National Association of Home Builders®) Green Building Standard and Guidelines and the ENERGY STAR® Indoor Air Package. For more information on Lennox Burn Smart products, go to www.lennoxhearthproducts.com/burnsmart.



DIMENSIONS

MONTECITO™

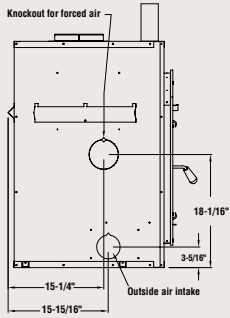

Left Side

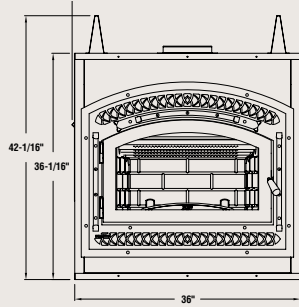

Front View

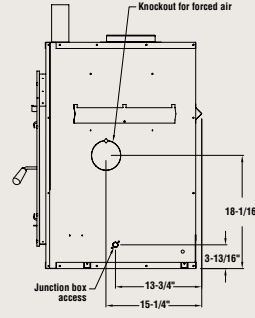

Right Side

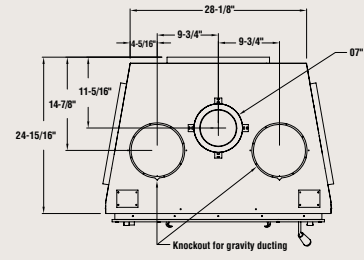

Top View

MONTECITO ESTATE™

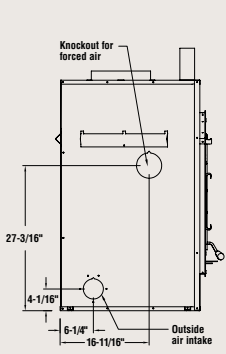

Left Side

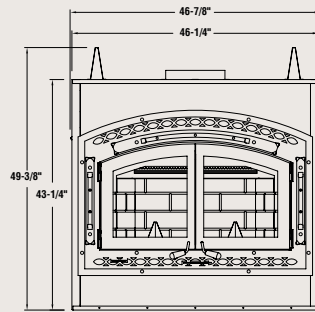

Front View

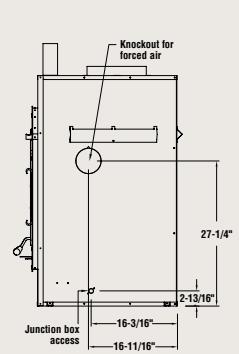

Right Side

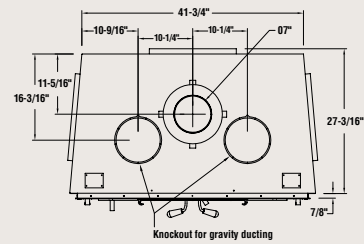

Top View

LADERA™

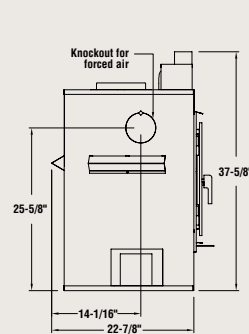

Left Side

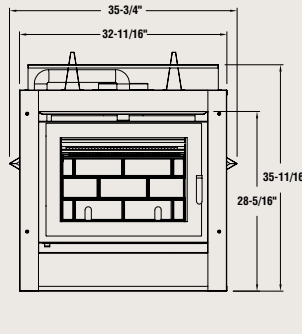

Front View

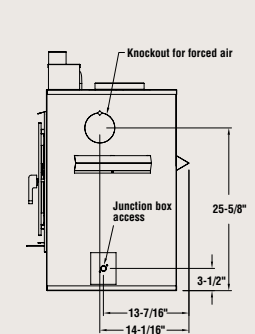

Right Side

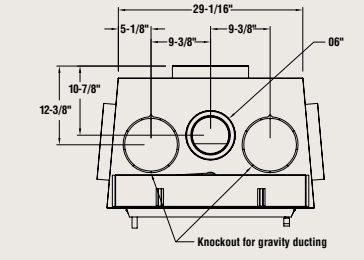

Top View

BRENTWOOD™

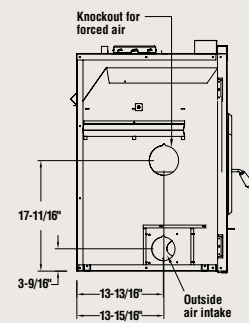

Left Side

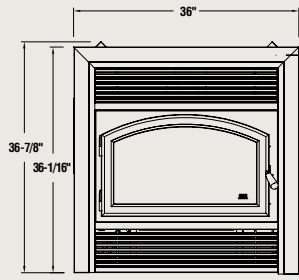

Front View

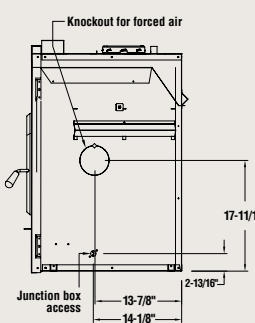

Right Side

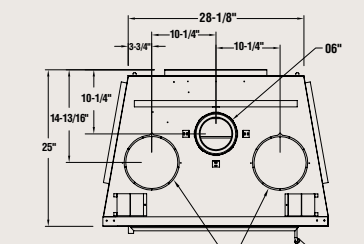

Top View

DIMENSIONS

BRENTWOOD™ LV

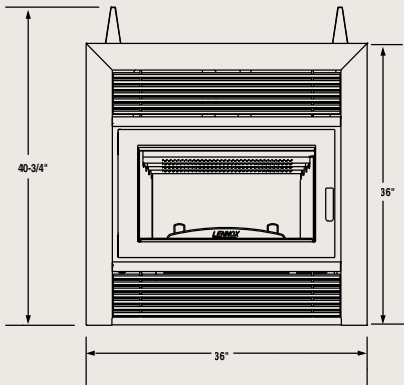

Front View

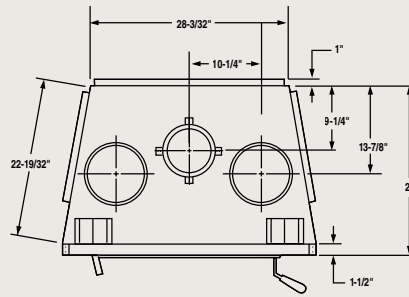

Top View

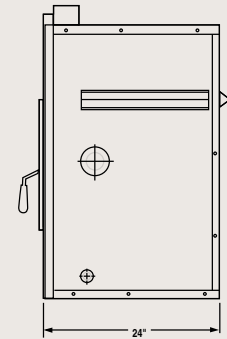

Side View

VILLA VISTA™

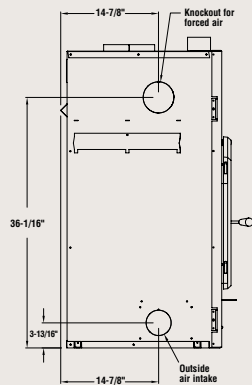

Left Side

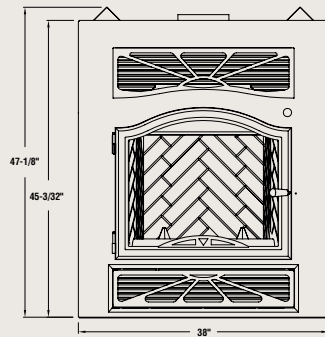

Front View

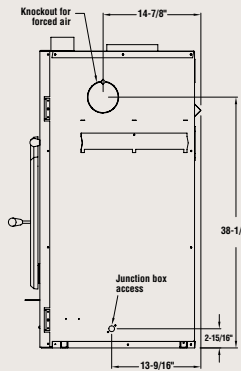

Right Side

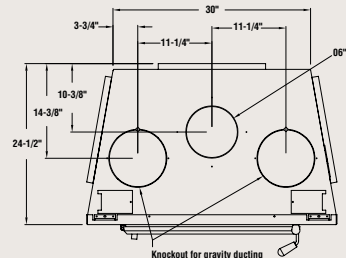

Top View

MULTI-ROOM HEATING OPTIONS

Lennox Hearth Products' EPA-certified line of wood-burning fireplaces can be used to heat multiple rooms within your home with our gravity vent kit option. Through natural convection or with the aid of the heat-circulating fan, warm air can be directed up to 10 feet away into one or two adjacent rooms, giving you the flexibility to heat multiple areas. Heat the family room with the fireplace, and the dining room and upstairs bedroom with the gravity vent kit. Or you can choose to more efficiently heat a large space by directing heat through multiple vents.

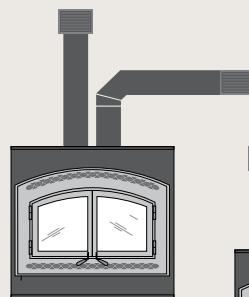

Heat up to two adjacent spaces with double-duct gravity vent kit

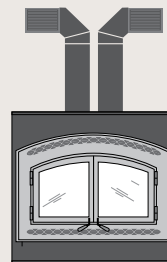

Distribute heat through multiple vents into one large space

Note: For maximum effectiveness, use double-duct gravity vent kit with a clean-face panel kit or when top-louvers are covered.

ENGINEERED TO BE THE BEST – COMMON FEATURES

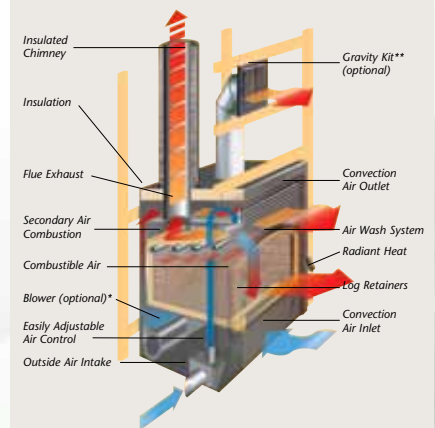

*Blower is an optional accessory with the Brentwood™ and Villa Vista fireplace models. It is included with the Ladera™, Montecito™ and Montecito Estate™ models.

**Only one duct of the double-duct system is shown in the image.

EXPERIENCE THE WARMTH

Choose the right fireplace to fit your personality.



| Feature Comparison | | | | | | |
|----------------------------|-------------------|--------------------|----------------------|--------------------|--------------------|------------------|
| Glass viewing area (W x H) | 31" x 15" | 22.5" x 12.25" | 20" x 13.25" | 22.5" x 12.25" | 22.5" x 12.25" | 22.5" x 19" |
| Firebox (W x H x D*) | 31" x 14.5" x 14" | 22" x 11.75" x 12" | 19.5" x 13.25" x 12" | 22" x 11.75" x 12" | 22" x 11.75" x 12" | 22" x 20" x 15" |
| Cu. ft. | 4.0 cu. ft. | 2.0 cu. ft. | 2.0 cu. ft. | 2.0 cu. ft. | 2.0 cu. ft. | 3.8 cu. ft. |
| Maximum log size | 30" | 19" | 18" | 19" | 19" | 20" |
| Chimney type/Flue size | S-2100+/GX 7" | ASHT+ 6" | ASHT+ 6" | ASHT+ 6" | ASHT+ 6" | ASHT+ 7" |
| EPA rating | 7.4 gr./hr | 3.7 gr./hr | 4.8 gr./hr | 3.7 gr./hr | 3.7 gr./hr | 4.0 gr./hr |
| BTU/hr | 80,000 | 55,000 | 50,000 | 55,000 | 55,000 | 70,000 |
| Heating capacity, up to** | 2,500 sq. ft. | 1,500 sq. ft. | 1,500 sq. ft. | 1,500 sq. ft. | 1,500 sq. ft. | 2,500 sq. ft. |
| Efficiency | 86.7% | 86.6% | 79.8% | 86.6% | 86.6% | 75% |
| Blower | 200 CFM | 200 CFM | 130 CFM | Optional | Optional | Optional |
| Ash pan | N/A | N/A | N/A | N/A | N/A | Yes |
| Weight | 475 lbs. | 303 lbs. | 215 lbs. | 278 lbs. | 300 lbs. | 403 lbs. |
| Warranty | Limited lifetime | Limited lifetime | Limited lifetime | Limited lifetime | Limited lifetime | Limited lifetime |

*Measured in front of door.

**Heating capacity—actual performance may vary depending upon home design and insulation, ceiling heights, climate, condition and type of wood used, appliance location, burn rate, accessories chosen, chimney installation and how the appliance is operated.



HEARTH PRODUCTS

© Lennox Industries Inc. 2011

Visit us at www.lennox.com, or contact us at 1-800-9-LENNOX

785273M 05/11

IMPORTANT NOTES:

As with any heating appliance, fireplace or stove, this appliance is extremely hot during operation. Read and understand all operating instructions before using this appliance. For further information, consult your dealer.

Diagrams, illustrations and photographs are not to scale—consult installation instructions. Product designs, materials, dimensions, specifications, colors and prices are subject to change or discontinuance without notice.



100% recycled