

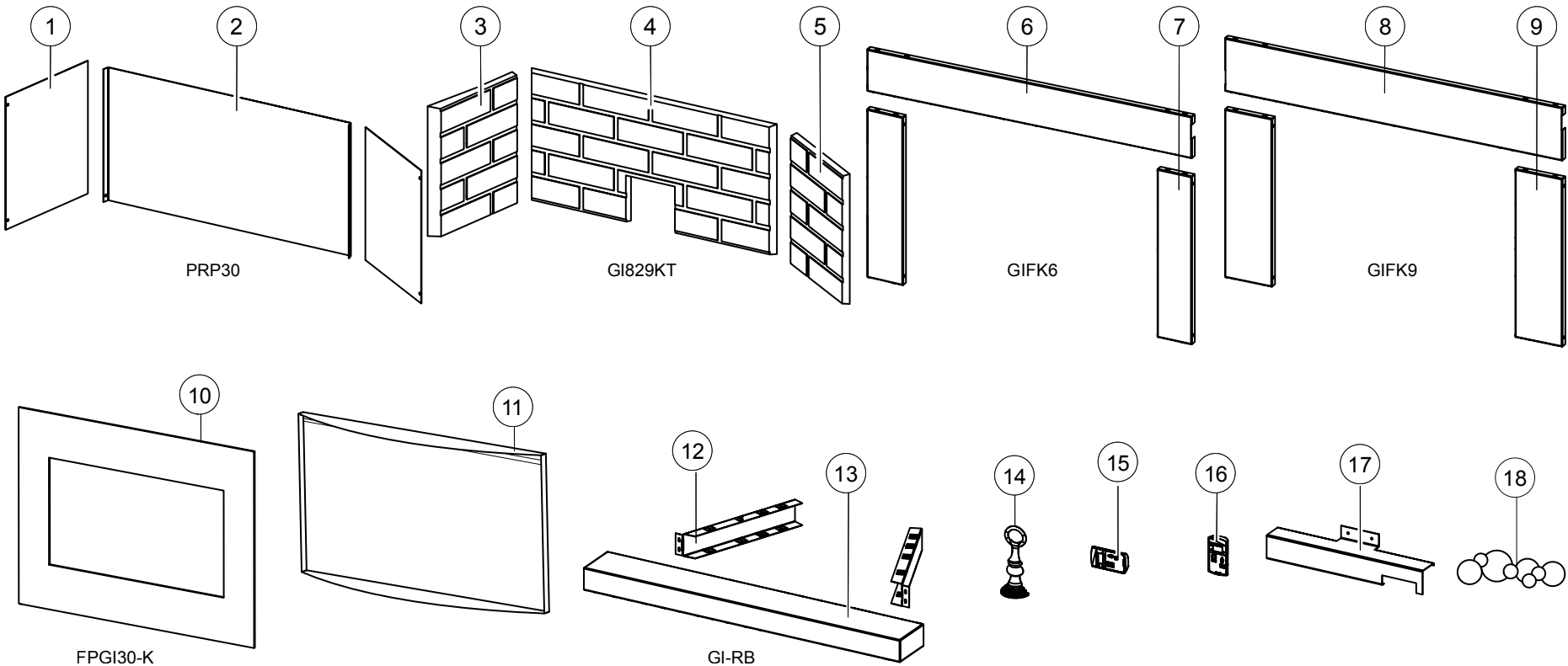

1-800-968-8604

*Extinguishing mediocrity online since 1999*

# GDI-30N ACCESSORIES



ITEMS MAY NOT APPEAR EXACTLY AS ILLUSTRATED

REF. NO.	PART NUMBER	DESCRIPTION
1	W090-0117	SIDE PORCELAIN PANEL (X2) (PRP30)
2	W090-0178	REAR PORCELAIN PANEL (PRP30)
3	W475-0299	LS SANDSTONE BRICK PANEL (GI829KT)
4	W475-0297	REAR SANDSTONE BRICK PANEL (GI829KT)
5	W475-0298	RS SANDSTONE BRICK PANEL (GI829KT)
6	W263-0182	6" TOP FLASHING (GIF_6)
7	W263-0181	6" SIDE FLASHING (X2) (GIF_6)
8	W263-0184	9" TOP FLASHING (GIFK9)
9	W263-0185	9" SIDE FLASHING (X2) (GIFK9)
10	W715-1006	FACEPLATE (FPGI30-K)

REF. NO.	PART NUMBER	DESCRIPTION
11	W010-3470	SAFETY BARRIER ASSEMBLY (??)
12	W525-0022	RAIL (X2) (GI-RB)
13	W715-0561	HEARTH TRIM (GI-RB)
14	W135-0148	ANDIRON (ANI-K / ANI-G)
15	W660-0081	WALL MOUNTED THERMOSTAT
16	F45 / F60	HANDHELD REMOTE CONTROL
17	RAK30	ROCK ADAPTOR KIT
18	MKRY / MKRM	RIVER ROCKS MEDIA KIT