

Addendum Instructions for Installing Block-Off Baffle on IHP Direct-Vent Gas Fireplaces

Applicable Rear-Vent Models Listed Below*

For more information, visit IHP.US.com

This addendum is in addition to the Installation and Operation Manuals provided with the models listed in **Table 1**. Use these instructions when installing the provided Block-Off Plate on **Rear-Venting Fireplaces only**.

*Table 1
Applicable Superior® Models - Manuals 900298-00 & 900285-00
DRT3035 / DRT3535
DRC3035 / DRC3535
DRT3040 / DRT3540
DRC3040 / DRC3540
Applicable Superior Models - Manuals 900414-00
MHD35 / MHD40
Applicable Astria® Models - Manuals 900298-01 & 900285-01
Gemini 35 / Scorpio 35
Gemini CD35 / Scorpio CD35
Gemini 40 / Scorpio 40
Gemini CD40 / Scorpio CD40
Applicable Comfort Flame™ Models - Manuals 900475-00 & 900474-00
Aurora 35 / Aurora 40
Aurora CD35 / Aurora CD40
Madison 35 / Madison 40

NOTE: The block-off panel and the baffle panel in **Figures 1-3** are shown unpainted for clarity. Panels on production unit are painted black.

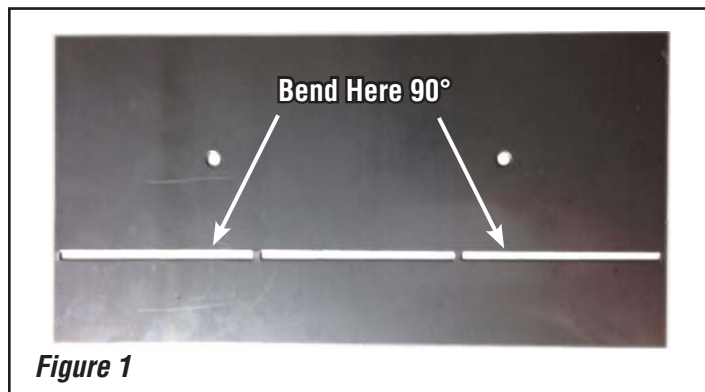

Installation Instructions:

1. Locate the supplied Baffle Block-Off Plate and bend 90° at location shown in **Figure 1**.
2. Locate and remove the (2) screws in the existing baffle located in the upper-rear interior of the fireplace (**Figure 2**).
3. Install the bent Baffle Block-off Plate as shown in **Figure 3** using the (2) screws removed in the previous step.
4. Follow instructions of Installation and Operation Manual provided with the fireplaces listed in **Table 1**.

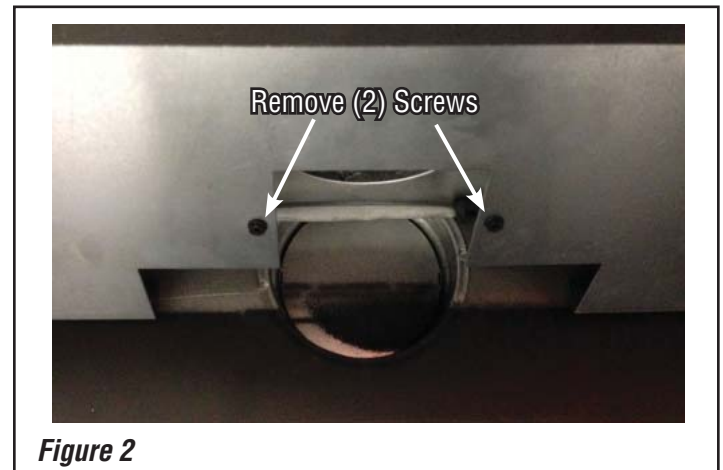

IHP reserves the right to make changes at any time, without notice, in design, materials, specifications, prices and also to discontinue colors, styles and products. Consult your local distributor for fireplace code information.