

NAPOLEON®

GAS BURNING

DIRECT VENT GAS FIREPLACES



napoleonfireplaces.com



Whether you follow your head or your heart, you'll still end up with a Napoleon®.

GD19 - The Vittoria™	4 - 5
GD33/34, BGD33/34	6 - 7
GD82T-PA - The Park Avenue™	8 - 9
GD36, BGD36	10 - 11
BGD36CF	12 - 13
BGD42, BGD42CF	14 - 15
HD35, HD40, HD46	16 - 17
HDX40	18 - 19
BGD40 - Multi-View Fireplaces	20 - 21
HD4 - Multi-View Series	22 - 23
GD70 - The STARfire™	24 - 25
GD80 - The Madison™	26 - 27
HD81 - High Definition See Thru	28 - 29
BGD90 - The Dream™	30 - 31
Napoleon's Outstanding Features	32 - 33
Options & Accessories	34 - 37
Detailed Specifications & Line Drawings	38 - 43



HD35 shown with painted black andirons and MIRRO-FLAME™ Panels



Why Napoleon®?

Making your life easier... Napoleon® fireplaces are designed to provide you absolute comfort and control at the touch of your fingertips. It's that easy. When you install a Napoleon® direct vent gas fireplace, you can rest assured that you will enjoy a lifetime of instant ambiance with reliable performance year after year.

An investment you can count on... Your new Napoleon® fireplace adds value to your home while at the same time giving you uncompromising comfort. Aside from kitchen and bathroom renovations, fireplaces add the highest return on your home investment.

Create your personal design statement... Surround yourself with a home environment that makes you feel good, relaxed and proud to reflect your decorating style. Hundreds of designer options are available to create the exact statement you have been looking for.

Highest efficiencies, maximum comfort... Years of research, design and testing have enhanced optimum performance allowing many Napoleon® products to achieve some of the highest heater rated efficiencies on the market. Napoleon® continuously surpasses industry standards not only in appearance but in efficiency and performance. See the benefits of Zone Heating on page 32.

Beautiful fires, best flame in the industry... With advanced burner technology and innovative design, Napoleon's flame and exclusive PHAZER® log sets are so realistic it's hard to tell the difference from a real wood burning fire.

No power? No problem!... We all feel vulnerable when the power goes out. Now you can weather out the storm in the comfort of your own home! A Napoleon® gas fireplace requires no electricity to light or operate, a built-in millivolt system or electronic ignition with battery back-up ensures reliability even during power failures.

Authorized dealer support network... With over 3,000 reputable authorized dealers across North America, Napoleon® works hard to provide professional, consistent training and technical education to support our dedicated team of professionals.

Outstanding reliable warranty... Each and every Napoleon® fireplace is designed and manufactured to strict quality testing standards and backed by the President's Limited Lifetime Warranty, guaranteed to give you the solid performance you deserve. Napoleon® is registered under the world recognized ISO 9001-2008 quality system.

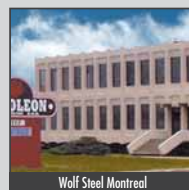

GD19 - The Vittoria™

Sleek, Tall and Slender

With its sleek, tall, slender design, the GD19 gas fireplace easily installs into smaller wall applications... perfect for entranceways and corner wall installations. With the choice of a traditional log set and facing kits or a river rock setting and contemporary facing kits, the GD19 offers two entirely different looks. The GD19 features Napoleon's exclusive NIGHT LIGHT™, electronic ignition with battery back-up and heat radiating ceramic glass. Either choice, traditional or modern, the GD19 is the perfect fireplace for smaller living spaces.

GD19

Up to 11,500 BTU's

45% flame/heat adjustment

20 1/2"w x 33 1/8"h as shown on page 5

Natural gas or propane

For more detailed specifications on this unit, see page 38

Options & Accessories



Contemporary Facing Kits
Two Colour Options*



Traditional Facing Kits
Two Colour Options*



Exclusive NIGHT LIGHT™



Ornamental Insets
Two Colour Options*



River Rock Burner Assembly



F45 & F60 Remote Controls
On/off or Modulating



GD19 shown with brushed stainless steel contemporary surround and river rock burner



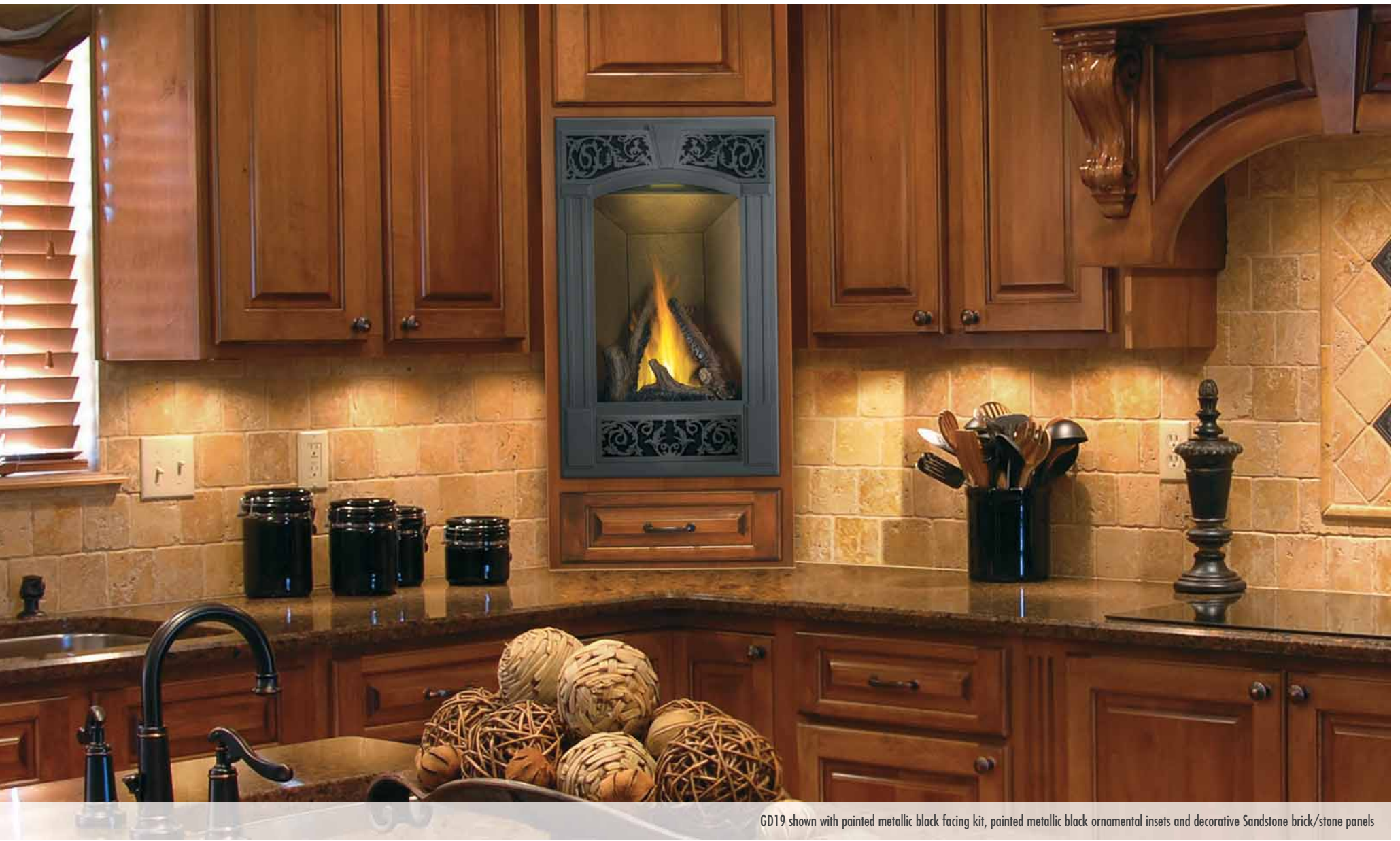

GD19 shown with painted metallic black facing kit, painted metallic black ornamental insets and decorative Sandstone brick/stone panels



Decorative Sandstone
Brick/Stone Panels



MIRRO-FLAME
Porcelain Reflective
Radiant Panels



33/34 Series Fireplaces

It's a Small World

The GD33/34 is one of Napoleon's smallest direct vent gas fireplaces and perfect for rooms with limited space. At only 13" deep, the GD33/34 can be installed almost anywhere! The 33/34" series features Napoleon's PHAZER® log set and glowing embers that are so realistic they look like a real wood fire. The 100% SAFE GUARD™ gas control system quickly and automatically shuts off the gas for your peace of mind. Easily transform your room into a relaxing, cozy retreat with just the right amount of heat. Available as a top vent (GD/BGD34) or rear vent (GD/BGD33).

GD33/34
 Up to 22,000 BTU's
 34 1/4" w x 29 5/8" h as shown
 Natural gas or propane

BGD33/34
 Up to 16,400 BTU's
 34 1/4" w x 29 5/8" h as shown
 Natural gas or propane

For more detailed specifications on these units, see page 38

Options & Accessories

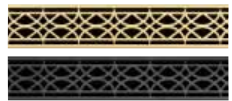

Bay Ornamental Insets
 Two Colour Options*



Louvres
 Four Colour Options*



Bevelled Trim Kits
 Three Colour Options*



Andirons
 Two Colour Options*



F45 & F60 Remote Controls
 On/off or Modulating



Bay Front Kit



GD33 shown with bay front, safety screen and painted black ornamental inset





GD34 shown with painted black bevelled trim kit, painted black louvres and decorative Sandstone brick panels



Decorative Sandstone
Brick Panels



MIRRO-FLAME
Porcelain Reflective
Radiant Panels



GD82T-PA - The Park Avenue™

European Styling

This tall, dark, handsome fireplace features a unique, clean design with advanced burner technology, creating the most realistic flames in the industry. The Park Avenue™ deluxe model is offered as a complete package including an exclusive NIGHT LIGHT™, heat circulating blower, multi-function remote control (controlling the flame, blower and NIGHT LIGHT™) and PHAZERAMIC™ advanced flame burner technology. Exclusive designer accessories make the Park Avenue™ perfect for any room in your home.

GD82T-PA

Up to 26,000 BTU's

50% flame/heat adjustment

24" w x 32 3/4" h as shown

Natural gas or propane

For more detailed specifications on this unit, see page 39



Shown with painted black rectangular facing kit and sandstone Herringbone panels

Options & Accessories



Rectangular Facing Kits
Four Colour Options*



Brushed Stainless Steel
Surround & Hearth Kit



Exclusive NIGHT LIGHT



Arched Facing Kit
Heritage Pattern



Arched Facing Kit
Lattice Pattern



Andirons
Two Style Options*



Remote Control
(Standard)



GD82T-PA shown with arched facing kit in painted black and Sandstone Herringbone decorative brick panels



Fluted Sandstone Brick



Fluted Brick with
Napoleon® Insignia



Sandstone Herringbone
Decorative Brick Panels



MIRRO-FLAME®
Porcelain Reflective
Radiant Panels



36" Fireplaces

Discover a World of Possibilities

The 36" gas fireplaces are without a doubt Napoleon's best sellers. These highly efficient gas fireplaces feature Napoleon's 100% SAFE GUARD™ gas control system that quickly and automatically shuts off the gas for your peace of mind. Napoleon's 36" gas fireplaces feature a multitude of designer options offering hundreds of different looks to match any décor. The heat radiating glass, beautiful display of YELLOW DANCING FLAMES™ and realistic PHAZER® logs make it the perfect addition for any room in your home.

GD36

Up to 26,000 BTU's
37 1/4"w x 33"h as shown
Natural gas or propane

BGD36

Up to 18,000 BTU's
36"w x 32 3/8"h as shown
Natural gas or propane



BGD36 shown with painted black louvers

For more detailed specifications on these units, see page 39

Options & Accessories



Ornamental Insets
Three Colour Options*



Louvers
Four Colour Options*



Bevelled Trim Kits
Four Colour Options*



Cast Iron Surround
Painted Black Finish



Andirons
Two Colour Options*



Northern Door Kit
Three Colour Options*



Arched Door Kit
Two Colour Options*



Webbed Arched Door Kit
Two Colour Options*



Rectangular Door Kit
Painted Black Finish



F45 & F60 Remote Controls
On/off or Modulating



Bay Front Kit



GD36 shown with painted black louvres and Old Town Red[®] decorative brick panels



Decorative Sandstone
Brick Panels



Sandstone Herringbone
Decorative Brick Panels



Old Town Red[®]
Decorative Brick Panels



MIRRO-FLAME[™]
Porcelain Reflective
Radiant Panels



River Rock Media Kits
Two Colour Options*



36" Clean Face Fireplace

Crisp, Contemporary Design

Napoleon's popular 36" fireplace is also available as a clean face unit. The hideaway door allows easy access to the hidden control panel to complement the louvre-free view of the firebox. The heat radiating glass, beautiful display of YELLOW DANCING FLAMES®, realistic PHAZER® log set, optional surrounds and decorative panels make it a perfect complement to a crisp, contemporary design. The perfect fireplace for those wanting a traditional look but a clean face contemporary design, the BGD36CF gives you the best of both worlds.

BGD36CF
 17,000 BTU's
 40"w x 34"h as shown
 Natural gas or propane

For more detailed specifications on this unit, see page 39



BGD36CF shown with brown concave surround and multi-coloured river rock media kit



Options & Accessories



F45 & F60 Remote Controls
 On/off or Modulating



Satin Chrome Upper Door Trim



Andirons
 Two Colour Options*



Wave Surround**
 Two Colour Options*



Convex Surround**
 Two Colour Options*



Concave Surround**
 Two Colour Options*



BGD36CF shown with MIRRO-FLAME® panels



Decorative Sandstone
Brick Panels



MIRRO-FLAME®
Porcelain Reflective
Radiant Panels



River Rock Media Kits
Two Colour Options*



42" Fireplaces

Impressive View

The 42" fireplaces feature Napoleon's exclusive PHAZER® log set, glowing charcoal ember bed and 100% SAFE GUARD™ gas control system that quickly and automatically shuts off the gas for your peace of mind. The impressive large viewing area with MIRRO-FLAME™ Porcelain Reflective Radiant Panels (included with this unit) create four spectacular fires in one and fill the large firebox with an echo of beautiful YELLOW DANCING FLAMES®. Napoleon's 42" fireplace is also available in a clean face unit allowing you to add a contemporary design to any room in your home.

BGD42

Up to 28,500 BTU's

42" w x 35 1/2" h as shown

Natural gas or propane

BGD42CF

Up to 24,000 BTU's

46" w x 37" h as shown

Natural gas or propane

For more detailed specifications on these units, see page 40

Options & Accessories



Ornamental Insets (BGD42)
Two Colour Options*



Louvers (BGD42)
Three Colour Options*



F45 & F60 Remote Controls
On/off or Modulating



Andirons
Two Colour Options*



Cast Iron Surrounds (BGD42)
Porcelain Enamel Majolica Brown Finish



BGD42 shown with painted black louvers



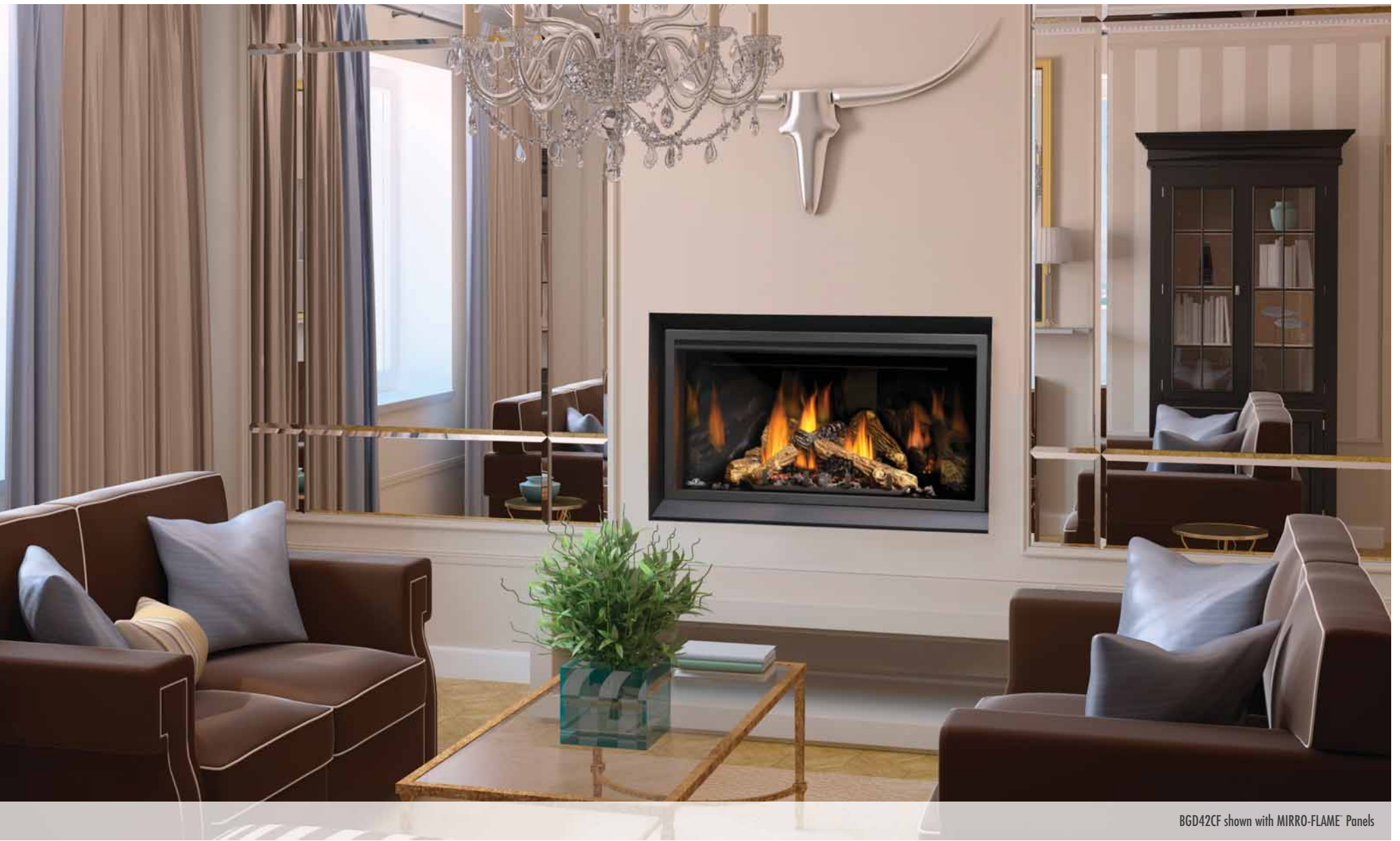

BGD42CF shown with MIRRO-FLAME® Panels



MIRRO-FLAME®
Porcelain Reflective
Radiant Panels
(Standard)



35", 40", 46" HD Series Fireplaces

Experience a New Dimension of Fire and Space

The clean face frame of the HD Series maximizes the viewing area so the realistic flames and PHAZER® log set are enjoyed to their fullest. Contemporary or traditional decorative accessories are available to complement any décor. These fireplaces are equipped with fuel saving electronic ignition with battery back-up and Napoleon's advanced burner technology. The simple yet sophisticated design of Napoleon's HD Series fireplaces provide every comfort a homeowner needs to create a relaxing environment. Perfect for any room in your home.

HD35

Up to 25,000 BTU's
43% flame/heat adjustment
35 ¼"w x 41"h as shown
Natural gas or propane

HD40

Up to 27,000 BTU's
43% flame/heat adjustment
40 ¼"w x 41"h as shown
Natural gas or propane

HD46

Up to 30,000 BTU's
43% flame/heat adjustment
46 ¼"w x 41"h as shown
Natural gas or propane

For more detailed specifications on these units, see page 40 & 41



HD35 shown with MIRRO-FLAME® Panels and river rock media tray

Options & Accessories

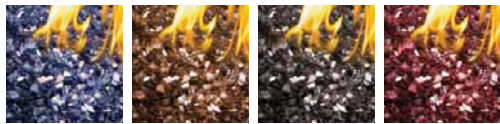

Glass Media Enhancement Kits
Four Colours Available*



GEO Shapes Media
Enhancement Kit



Bevelled Trim Kits
Two Colour Options*



Andirons
Painted Black Finish



Four-Sided Frames
Three Colour Options*



Modern Faceplate with
Operable Screen Doors



Contemporary Decorative Door Kit
with Operable Screen Doors



River Rock Media Tray with
Satin Chrome Decorative Fender



F45 & F60 Remote Controls
On/off or Modulating



HD40 shown with contemporary decorative door kit and painted black andirons



HD46 shown with painted black andirons and MIRRO-FLAME Panels



Decorative Sandstone Brick Panels



Mayan Desert Sandstone Brick Panels



MIRRO-FLAME Porcelain Reflective Radiant Panels



MIRRO-FLAME Ribbed Porcelain Reflective Radiant Panels



River Rock Media Kits
Two Colour Options*



HDX40 - Deluxe HD Series Fireplace

Inspired Design

Inspired by traditional masonry details and created with Napoleon's state-of-the-art gas fireplace technology, the deluxe HDX40 offers the ultimate in performance and design. The clean face front allows a full view of the impressive 40" wide firebox with your choice of either fine detailed PHAZER® logs and charcoal embers or a river rock ember bed. The HDX40 comes complete with a modulating remote (controls heat, optional blower, exclusive NIGHT LIGHT), fuel saving electronic ignition with battery back-up and built-in flame/heat control making the HDX40 a perfect investment for your lifestyle and your home.

HDX40

Up to 40,000 BTU's

54% flame/heat adjustment

40 1/4" w x 41" h as shown

Natural gas or propane

For more detailed specifications on this unit, see page 41



HDX40 shown with Newport® deluxe decorative brick panels

Options & Accessories



Glass Ember Media Enhancement Kits
Four Colours Available*



Bevelled Trim Kits
Two Colour Options*



Andirons
Painted Black Finish



Remote Control
(Standard)



Four-Sided Frames
Three Colour Options*



Modern Faceplate with
Operable Screen Doors



Contemporary Decorative Door Kit
with Operable Screen Doors



Premium Scalloped Wrought Iron
Face Trim and Door



Exclusive NIGHT LIGHT



HDX40 shown with premium scalloped wrought iron face trim & door and Newport[®] deluxe decorative brick panels



Decorative Sandstone
Brick Panels



Mayan Desert[®]
Sandstone Brick Panels



Newport[®] Deluxe
Decorative Brick Panels



MIRRO-FLAME[®]
Porcelain Reflective
Radiant Panels



MIRRO-FLAME[®] Ribbed
Porcelain Reflective
Radiant Panels



River Rock Media Kits
Two Colour Options*



BGD40 - Multi-View Fireplaces

Discover a World of Possibilities

The BGD40 Multi-View fireplaces are perfect for adding a focal point to the corner of any room. Two corner models are available to suit any possibility; a left corner and a right corner. Napoleon's PHAZER® log set and YELLOW DANCING FLAMES™ are so realistic it's hard to tell the difference from a real wood burning fire. Design an attractive corner in any room of your room with a Napoleon® BGD40.

BGD40 - Corner Models

Up to 30,000 BTU's

36" w x 32 1/2" h as shown

Natural gas or propane

For more detailed specifications on these units, see page 41

Options & Accessories



Louvers
Painted Black Finish



F45 & F60 Remote Controls
On/off or Modulating



BGD40 shown with painted black louvers





BGD40 shown with painted black louvres



Decorative Sandstone
Brick Panels (Standard)



HD4 - Multi-View Series

Exceptional Focal Point

Napoleon's new HD4 Multi-View Series is available as a See Thru or a three-sided Peninsula and features various firebox/burner configurations including a log burner (HD4ST/HD4P), a linear topaz glass burner (HD4STG/HD4PG) or a designer fire cradle complete with exclusive topaz glass (HD4STFC/HD4PFC). With a massive 1,000 sq. in. viewing area, multiple firebox configurations, electronic ignition with battery back-up, optional zen modern door kits, contemporary rectangular door kits, media kits and decorative panels the HD4 will match any room in your home.

HD4ST / HD4STG / HD4STFC	HD4P / HD4PG / HD4PFC
Up to 30,000 BTU's	Up to 30,000 BTU's
38 1/4"w x 32 1/4"h as shown	37 3/8"w x 32 1/4"h as shown
Natural gas or propane	Natural gas or propane

For more detailed specifications on these units, see page 42



HD4PG shown with seven piece trim kit



Options & Accessories



Glass Ember Media Enhancement Kits
Four Colours Available*



Designer Fire Art
Nickel Stix & Metal Coil



F45 & F60 Remote Controls
On/off or Modulating



Safety Screen



Zen Modern Door Kit
Two Colour Options*



Contemporary Rectangular Front
Two Colour Options*



Three Piece Trim Kit
Painted Black Finish



Seven Piece Trim Kit
Painted Black Finish



One Piece Surround
Textured Black Finish



HD4STFC shown with standard topaz glass embers



HD4ST shown in non-combustible facing material with optional Newport® decorative brick panels



Newport® Deluxe
Decorative Brick Panels



MIRRO-FLAME
Porcelain Reflective
Radiant Panels



Glass Ember Media Kits
Blue, Amber, Black, Red, Clear, Topaz (Standard with HD4PG / HD4STG / HD4PFC / HD4STFC)



River Rock Media Kits
Two Colour Options*
(For FC Units Only)



GD70 - The STARfire™

One of a Kind

The STARfire™ offers you a wide range of heat output and control with a remarkable 50% flame/heat adjustment. The PHAZERAMIC™ advanced burner technology with glowing ember bed produces stunning YELLOW DANCING FLAMES®. With a large viewing area, realistic PHAZER® log set that's rich in colour and detail and Napoleon's exclusive NIGHT LIGHT™ the STARfire™ is a one of a kind fireplace that you will be proud to show to family and friends! The perfect fit for great rooms and large family rooms.

GD70

Up to 35,000 BTU's

50% flame/heat adjustment

37 1/4" w x 36" h as shown

Natural gas or propane

For more detailed specifications on this unit, see page 42



GD70 shown with decorative faceplate and operable doors



Options & Accessories

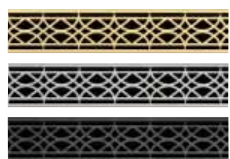

Ornamental Insets
Three Colour Options*



Louvres
Four Colour Options*



Bevelled Trim Kits
Three Colour Options*



Cast Iron Surrounds
Porcelain Enamel Majolica
Brown Finish



Andirons
Two Colour Options*



Faceplate/Door Kit with
Upper & Lower Louvres



Decorative Faceplate
Three Colour Options*



Premium Scalloped Steel
Faceplate and Door



F45 & F60 Remote Controls
On/off or Modulating



Bay Front Kit



Exclusive NIGHT LIGHT



GD70 shown with premium scalloped steel faceplate and door with Old Town Red[®] decorative brick panels



Decorative Sandstone
Brick Panels



Sandstone Herringbone
Decorative Brick Panels



Old Town Red[®]
Brick Panels



MIRRO-FLAME[®]
Porcelain Reflective
Radiant Panels



GD80 - The Madison™

Old World Charm

The Madison™ rekindles the romantic era when sitting by the fire melted away the chills of the world outside. An open look of a real wood burning fireplace emerges with all the conveniences of direct vent technology. The Madison™ comes fully equipped with a multi-function remote control (adjusting flame, heat, blower and exclusive NIGHT LIGHT), elegant solid cast iron andirons and grate, heat circulating blower, safety pull screen and advanced burner technology. All this and the choice of either a wrought iron faceplate or a traditional arched or rectangular door design to complement your decor.

GD80

Up to 43,000 BTU's

50% flame/heat adjustment

37 1/4" w x 30" h as shown

Natural gas or propane

For more detailed specifications on this unit, see page 43



GD80 shown with MIRRO-FLAME Panels



Options & Accessories



Rectangular Facing Kit



Arched Facing Kit



Decorative Arched Frame



Exclusive NIGHT LIGHT



Rectangular Decorative Doors
Two Colour Options*



Arched Decorative Doors
Two Colour Options*



Wrought Iron Faceplate with
Operable Doors



Remote Control
(Standard)



Andirons (Standard)
Painted Black Finish



GD80 shown with arched hammertone copper decorative doors and Old Town Red[®] decorative brick panels



Decorative Sandstone
Brick Panels



Sandstone Herringbone
Decorative Brick Panels



Old Town Red[®]
Brick Panels



MIRRO-FLAME[®]
Porcelain Reflective
Radiant Panels



HD81 - High Definition See Thru

Two Exceptional Views

The first See Thru fireplace in the industry to offer such dynamic choices for firebox design options. The HD81 features Napoleon's exclusive NIGHT LIGHT™ that radiates a warm glow into the room(s) even when the fireplace is off and a split burner system that produces beautiful YELLOW DANCING FLAMES®. Besides supplying two rooms with exceptional focal points, the HD81 also offers the choice of a traditional PHAZER® log set, a modern CRYSTALLINE™ ember bed or a glowing river rock setting. One fireplace, two rooms, exceptional views!

HD81

Up to 60,000 BTU's

72% flame/heat adjustment

39" w x 33 1/2" h as shown

Natural Gas or propane

For more detailed specifications on these units, see page 43

Options & Accessories

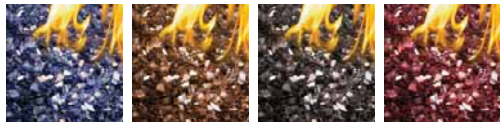

Glass Ember Media Enhancement Kits
Four Colours Available*



Bevelled Trim Kit
Painted Black Finish



Polished Chrome Accent Trim



Exclusive NIGHT LIGHT



Andirons
Painted Black Finish



Remote Control
(Standard)

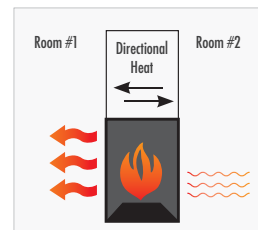

SPLIT ZONE Control

Blower can operate out of either or both sides, fully adjustable for directing air flow - in whichever room you prefer extra heat.



HD81 shown with river rock burner and black bevelled trim kit





HD81 shown with glass burner, clear glass media kit, MIRRO-FLAME® Panels and black bevelled trim kit



HD81 shown with log burner, decorative Sandstone brick panels and black bevelled trim kit



Decorative Sandstone
Brick Panels



MIRRO-FLAME®
Porcelain Reflective
Radiant Panels



Glass Ember Media Kits
Blue, Amber, Black, Red, Clear, Topaz (Standard)



BGD90 - The Dream™

Largest Gas Fireplace in The Industry

Napoleon® is extremely pleased to offer such an extraordinary fireplace for discriminating customers who want to set themselves apart. This colossal fireplace has the phenomenal viewing area of 16 square feet, sure to capture anyone's attention that enter the room. With its astounding design, the Dream™ is the perfect fireplace to make a statement in any home. The Dream™ features Napoleon's PHAZER® log set, exclusive NIGHT LIGHT™ and double burner system which showcases two incredible displays of YELLOW DANCING FLAMES®. Ideal for a great room, large bedroom, ski lodge, lobby or castle.

BGD90

Up to 50,000 BTU's

50% flame/heat adjustment

49 1/2"w x 49 1/2"h as shown

Natural gas or propane

For more detailed specifications on this unit, see page 43

Options & Accessories



Country Crane
and Hearth Pot



Remote Control
(Standard)



Andirons (Standard)
Painted Black Finish



Wrought Iron Decorative
Door Frame



Artisan Wrought Iron
Decorative Double Doors



Dual NIGHT LIGHT™
(Standard)



BGD90 shown with wrought iron decorative door frame





BGD90 shown with artisan wrought iron decorative double doors and country crane and hearth pot



Sandstone Herringbone
Decorative Brick Panels



Outstanding Features

of Napoleon's Advanced Technology



Advanced Burner Technology

Napoleon's sophisticated burner system offers superior flame technology. Strategically placed burner ports create the most realistic YELLOW DANCING FLAMES® in the industry.

Finely Tuned Precision Valves

Surrounded with a protective cast aluminum jacket, the precision valves allow for ultimate reliability and 100% SAFE GUARD® gas control system.

Minimum 30% savings on heating costs with Zone Heating

Zone Heating means you are heating the rooms that you use the most with an alternate heat source, like a Napoleon® heater rated gas fireplace. Zone Heating is the obvious solution for families concerned about rising fuel costs.

Outstanding Craftsmanship

Fine details are designed in every aspect of Napoleon® fireplaces... individually handcrafted with pride of excellence to last a lifetime.

Solid Hinged Doors & Safety Screens

Manufactured with heavy gauge steel, the doors are conveniently hinged on most models for easy opening access. Safety screens are available to protect against inadvertent contact with glass, glass and unit temperature can get very hot.

Outstanding Features

of Napoleon's Direct Vent Technology

Direct Vent System

1. Zero clearance to combustible framing
2. Forced convection heated room air
3. Radiant heat
4. High Heat Ceramic or Tempered Glass increases the radiant heat that is dispersed throughout the room. Save up to 30% on energy costs with radiant heat and Zone Heating
5. Cool room air is naturally drawn through the lower opening, circulates around the firebox, and expels into the living space as warm air
6. Optional air circulating variable speed blower with high temperature bearings increases efficient heating
7. Advanced ceramic burner system (selected models)
8. MIRRO-FLAME[®] Porcelain Reflective Radiant Panels further increase radiant heat (optional on most models)
9. Advanced burner technology produces the most realistic flames in the industry
10. Sealed combustion chamber

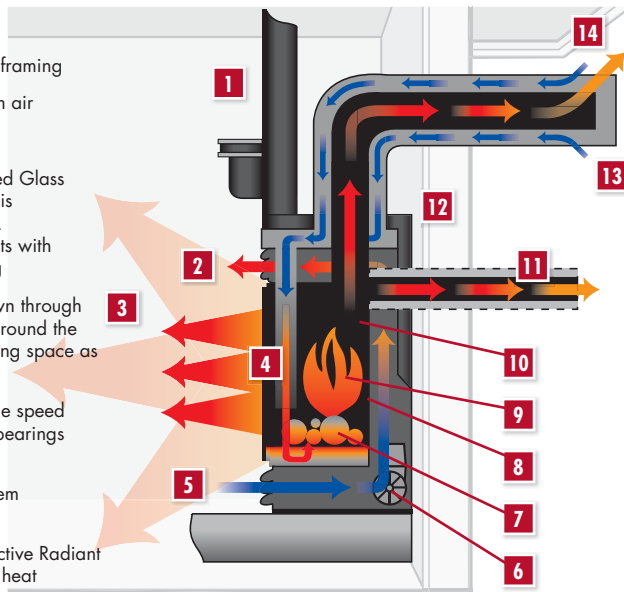

11. Optional rear exhaust (selected models)
12. Efficient heat exchange system
13. Combustion air inlet
14. Flue gas outlet

With over 35 years of research and development, Napoleon[®] has perfected direct vent technology to offer you a fireplace, stove or insert that easily fits into your lifestyle.

With Napoleon's direct vent technology, you can design and install your fireplace in unique locations where it wasn't possible before with traditional masonry fireplaces. Even your basement can be transformed into a warm, inviting oasis for your family and friends to enjoy.

Whether you are renovating, building or replacing an inefficient fireplace product, Napoleon[®] helps guide you in the right direction to find the product that's right for you and your home. Napoleon[®] Fireplaces are a smart investment that will bring many years of affordable luxury to you and your family.

Direct Vent Power Venting System

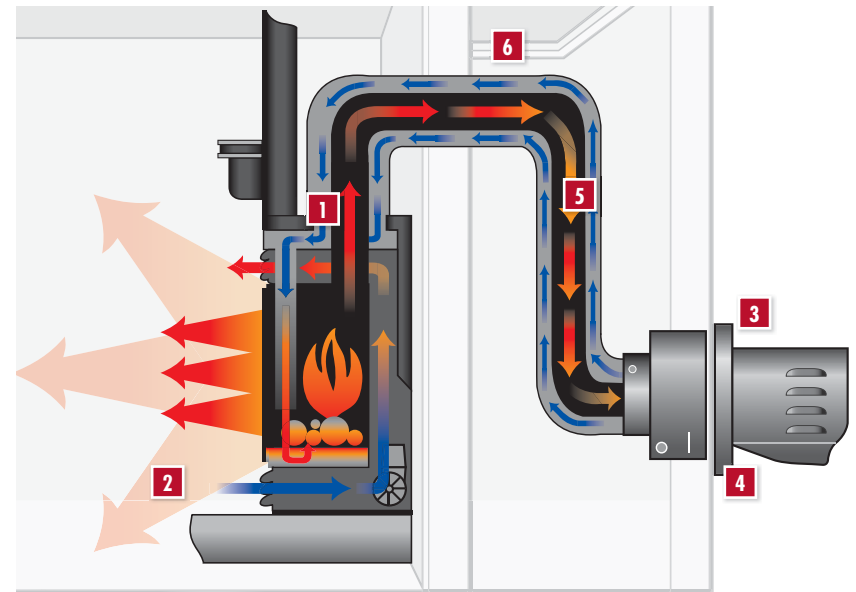

1. Suitable for exhaust products with various vent diameters
2. Installation friendly maintenance free durable construction
3. Blower mounted outside at terminal with WHISPER QUIET[®] operation inside
4. Terminates above or below the fireplace to allow more freedom and versatility for direct vent installations
5. No hoses to terminal
6. Ability to "snake" either up, down or around objects (ie; behind stairways)

Napoleon's power venting system allows more freedom and versatility for direct vent installations. The option of having the termination above or below the fireplace, along with the ability to "snake" either up or down, allows installation when the desired fireplace location is a great distance away from an outside wall. The blower that pulls the burned gases from the fireplace is mounted outside at the terminal which provides WHISPER QUIET[®] operation inside the home.

Available for Select Models

Decorative Panels



Decorative Sandstone Brick



Sandstone Herringbone Brick



Newport® Deluxe Brick



Mayan Desert® Sandstone Brick



Old Town Red® Brick



Sandstone Decorative Brick/Stone



Fluted Refractory Bricks



MIRRO-FLAME®
Porcelain Reflective Radiant Panels



MIRRO-FLAME®
Ribbed Porcelain Reflective Radiant Panels



Fluted Refractory Bricks
with Napoleon® insignia

Louvres



Antique Brass Finish



Brushed Stainless Steel Finish



Polished Brass Finish



Painted Black Finish

Ornamental Insets



24 Karat Gold Plated Finish



Brushed Stainless Steel Finish



Painted Black Finish



Brushed Stainless Steel Finish
Available for GD19 only



Painted Metallic Black Finish
Available for GD19 only



Burner Options

Napoleon's HD81, GD19 and HD4's offer different burner options to allow you to choose the burner configuration that best suits your home. See Options, Features & Accessories on page 37 for more information.



Media Enhancement Kits



River Rock Media

Switch out existing logs to a more contemporary setting with the optional river rock media kit. Available in grey or multi-coloured finishes.



Glass Media

Media enhancement kits of coloured glass are designed for random placement within the firebox as an addition to the ember bed.



Media Tray

River Rock Media Tray with Satin Chrome decorative fender



Burner Trim

Polished Chrome Accent Burner Trim
Designed Exclusively for the HD81 Rock Burner

Andirons

Designed to simply stand in front of the logs and give the optimum traditional masonry look and feel. They fit directly in a bay window, bay front kit or rest inside the firebox.



GEO Shapes

Take your modern fireplace one step further with Napoleon's six piece ceramic GEO shapes media enhancement kit.



Bevelled Trim Kits Available in 3" or 6"



Antique Brass Finish



Brushed Stainless Steel Finish



Polished Brass Finish



Textured Painted Black Finish

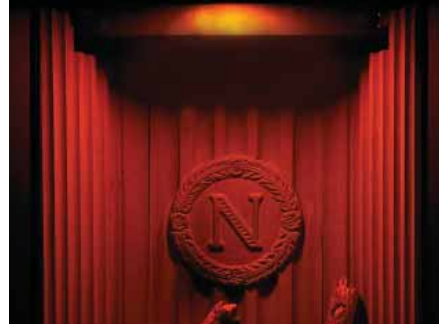

Exclusive NIGHT LIGHT™

The exclusive NIGHT LIGHT™ illuminates the whole decorative firebox, including the logs, even when the fireplace is turned off.



Convenient Remote Controls

Napoleon's remotes with digital read out and modulating control give you the comfort level you need at the touch of a button.

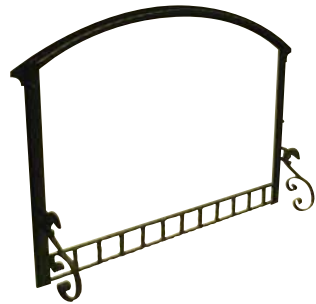

Decorative Arched Frame
Designed specifically for the GD80



Country Crane & Hearth Pot
Designed specifically for the BGD90



Mantel Collection

Napoleon's Mantel Collection presents our full line of mantels for any lifestyle, décor or setting. The Signature Series Collection combine centuries old craftsmanship with contemporary finishing and production techniques creating a one-of-a-kind masterpiece.

Cast Iron Surrounds



Porcelain Enamel Majolica Brown Finish



Painted Black Finish



WHISPER QUIET™

Heat Circulating Blower System

The extreme heat resistant "H" class bearings featured in Napoleon's superior heat circulating blower, create a lasting "whole home" comfort with adjustable high & low speeds.



Thermostat For Hot Air Distribution Kit

Optional thermostatic control maintains adjacent room temperature for even greater convenience.

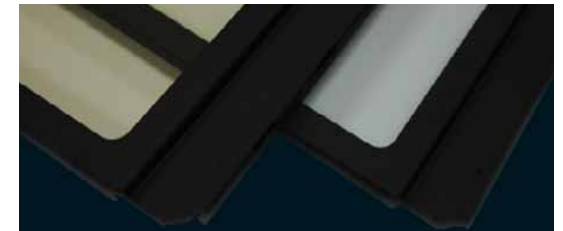

Superior Heat Resistant Glass

Ceramic and tempered glass are made to withstand high temperatures, allowing maximum radiant heat, performance and safety.

Hot Air Distribution Kit

With the hot air distribution kit and its independent fan control, you are offered a choice of distributing a portion of the heat generated from your fireplace to other rooms, adding to your overall home comfort... or when fireplace heating efficiency is secondary to the ambiance of a fire, disperse it outdoors... ideal for entertaining.

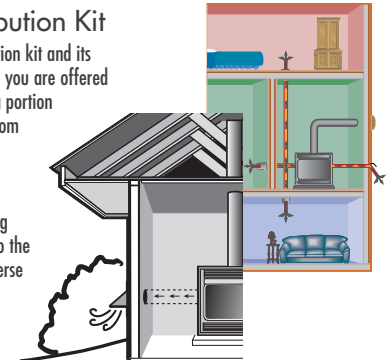

Decorative Door Kits



Arched Door
Available in Painted Black (shown) and 24 Karat Gold Plated finishes



Webbed Arched Door
Available in Painted Black and 24 Karat Gold Plated (shown) finishes



Northern Door
Available in Painted Black, Pewter (shown) and 24 Karat Gold Plated finishes



Rectangular Door
Available in Painted Black (shown) finish



HD4ST Zen Door
Available in Textured Black and Gun Metal Grey (shown) finishes



Modern Faceplate and Doors
Available for HD35, HD40, HD46 and HDX40 fireplaces



Contemporary Door Kit
Available for the HD35, HD40, HD46 and HDX40 in Painted Black finish.



GD70 Decorative Faceplate and Doors
Available in Painted Black (shown), Hammertone Pewter or Hammertone Copper finishes



GD80 Rectangular Decorative Doors
Available in Hammertone Pewter (shown) or Hammertone Copper finishes



GD80 Arched Decorative Doors
Available in Hammertone Pewter or Hammertone Copper (shown) finishes



GD80 Wrought Iron Faceplate & Doors
Hand-forged iron - solid handcrafted wrought iron faceplate complete with double arched doors



BGD90 Artisan Doors
Solid wrought iron rectangular "Artisan" double doors

Decorative Frames & Fronts



GD19 Traditional Facing Kit
Available in Painted Metallic Black or Hammertone Pewter (shown) finishes



GD19 Contemporary Front
Available in Brushed Stainless Steel (shown) or Painted Metallic Black finishes

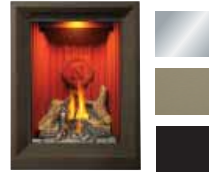

GD82T-PA Rectangular Facing Kit
Available in Diamond Dust Pewter, Taupe, Brown (shown) or Painted Black finishes



GD82T-PA Arched Facing Kit
Heritage Pattern
Painted Black finish



GD82T-PA Arched Facing Kit
Lattice Pattern
Wrought Iron finish



Wave, Convex & Concave Surrounds
Available in Diamond Dust Pewter and Brown finishes.
Wave/Convex/Concave surrounds come with top and hearth satin chrome trim (matching upper trim also available).



HD4ST Contemporary Rectangular Front
Available in Textured Black (shown) and Gun Metal Grey finishes



Premium Scalloped Frame & Door
Available for HDX40 and GD70 fireplaces



Four-Sided Frames
Available in Brown, Diamond Dust Pewter (shown) or Painted Black finishes



GD70 Faceplate/Door Kit
Designed for marble/tile backing or flush wall installation. Available in Painted Black finish



BGD90 Faceplate
Wrought iron decorative square frame with arched rail inset



GD82T-PA Brushed Stainless Steel Surround & Hearth

Available Colour Options



24 Karat Gold Plated Finish



Painted Metallic Black Finish



Brushed Stainless Steel Finish



Hammertone Pewter Finish



Hammertone Copper Finish



Textured Black Finish



Painted Black Finish



Diamond Dust Pewter Finish



Brown Finish



Taupe Finish



Gun Metal Grey Finish



Gloss Black Finish

Bay Front

Bay Front complete with pull seen and standard front brick available for GD/BGD33/34, GD/BGD36 and GD70.



	GD19	GD33	BGD33	GD34	BGD34	GD87FPA	GD36	BGD36	BGD36CF	GD42	BGD42CF	HD35	HD40	HD46	HDX40	BGD40	HD4 (ST)	HD4 (P)	GD70	GD80	HD81	BGD90
Louvres (*antique brass, polished brass, brushed stainless steel and painted black finishes)	-	0	0	0	0	-	0	0	-	0	-	-	-	-	-	0	-	-	0	-	-	-
Ornamental Insets	0	0	0	0	0	-	0	0	-	0	-	-	-	-	-	0	-	-	0	-	-	-
Bay Front Kit	-	0	0	0	0	-	0	0	-	-	-	-	-	-	-	-	-	-	0	-	-	-
3" Trim (*antique brass, polished brass, brushed stainless steel and textured painted black finishes)	-	0	0	0	0	-	0	0	-	-	-	0	0	0	0	-	-	-	0	-	0	-
6" Trim (*antique brass, polished brass, brushed stainless steel and textured painted black finishes)	-	-	-	-	-	-	0	0	-	-	-	-	-	-	-	0	-	-	0	-	-	-
Faceplate Kits	0	-	-	-	-	0	-	-	-	-	-	0	0	0	0	-	-	-	0	-	-	-
Safety Screen	-	-	-	-	-	-	0	0	0	0	0	-	-	-	-	0	0	0	-	S	-	S
Decorative Door Kits	-	-	-	-	-	-	0	0	-	-	-	0	0	0	0	0	-	-	0	0	-	0
Northern Decorative Door Kits	-	-	-	-	-	-	0	0	-	-	-	-	-	-	-	0	-	-	-	-	-	-
Cast Iron Surround Kit (porcelain enamel Majolica brown & painted black finishes)	-	-	-	-	-	-	0**	0**	-	0†	-	-	-	-	-	0**	-	-	0†	-	-	-
Clean Face Surround (concave, convex, wave)	-	-	-	-	-	-	-	-	0	-	-	-	-	-	-	-	-	-	-	-	-	-
Four-Sided Surrounds	-	-	-	-	-	-	-	-	0	-	-	0	0	0	0	-	-	-	-	-	-	-
Zen Modern Door Kit with Operable Doors (textured painted black and gun metal grey finishes)	-	-	-	-	-	-	-	-	-	-	-	-	-	-	-	-	0	0	-	-	-	-
Contemporary Rectangular Front (gloss black and gun metal grey finishes)	-	-	-	-	-	-	-	-	-	-	-	-	-	-	-	-	0	0	-	-	-	-
MIRRO-FLAME® Porcelain Reflective Radiant Panels	0	0	0	0	0	0	0	0	0	S	S	0	0	0	0	-	0	0	0	0	0	-
MIRRO-FLAME® Ribbed Porcelain Reflective Radiant Panels	-	-	-	-	-	-	-	-	-	-	-	0	0	0	0	-	-	-	-	-	-	-
Old Town Red® Brick Panels	-	-	-	-	-	-	0	-	-	-	-	-	-	-	-	-	-	-	0	0	-	-
Sandstone Herringbone Brick Panels	-	-	-	-	-	0	0	-	-	-	-	-	-	-	-	-	-	-	0	0	-	0
Sandstone Decorative Brick Panels	-	0	-	0	-	-	0	-	0	-	-	0	0	0	0	S	-	-	0	0	0	-
Sandstone Decorative Brick / Stone Panels	0	-	-	-	-	-	-	-	-	-	-	-	-	-	-	-	-	-	-	-	-	-
Mayan Desert® Decorative Brick Panels	-	-	-	-	-	-	-	-	-	-	-	0	0	0	0	-	-	-	-	-	-	-
Newport® Deluxe Decorative Brick Panels	-	-	-	-	-	-	-	-	-	-	-	-	-	0	-	0	0	-	-	-	-	-
Traditional Andirons (painted black and 24 Karat gold plated finishes)	-	0	0	0	0	0**	0	0	0	0	0	0**	0**	0**	0**	0	-	-	0	S**	0**	S**
River Rock Media Kit (grey or multi-coloured finishes) / Burner Configuration	0	-	-	-	-	-	0	0	0	-	-	0	0	0	0	-	0°	0°	-	-	0	-
Glass Ember Media Kit (blue, amber, black, red and clear) / Burner Configuration	-	-	-	-	-	-	-	-	-	-	-	0	0	0	0	-	0°	0°	-	-	0	-
Designer Fire Art - Nickel Stix	-	-	-	-	-	-	-	-	-	-	-	-	-	-	-	-	0	0	-	-	-	-
Designer Fire Art - Metal Coil	-	-	-	-	-	-	-	-	-	-	-	-	-	-	-	-	0	0	-	-	-	-
Exclusive NIGHT LIGHT	S	-	-	-	-	S	-	-	-	-	-	-	-	-	S	-	-	-	S	S	S	S
Heat Circulating Blower Kit	0	0	0	0	0	S	0	0	0	0	0	0	0	0	0	0	-	-	0	S	0	0
Hot Air Distribution Kit/Exhaust Kit	-	0	0	0	0	0	0	0	0	0	0	0	0	0	0	-	-	-	0	0	0	0
Millivolt Wall Thermostat	0	0	0	0	0	0	0	0	0	0	0	0	0	0	0	0	-	-	0	-	-	-
On/off or Modulating Remote with Digital Screen	0	0	0	0	0	-	0	0	0	0	0	0	0	0	0	0	0	0	0	-	-	-
Standard Modulating Remote - Controls flame and blower	-	-	-	-	-	S	-	-	-	-	-	-	-	-	S	-	-	-	-	S	S	S
Modulating Valve Regulator with Remote Control	-	-	-	-	-	-	-	-	-	-	-	-	-	-	-	-	0	0	-	-	-	-
Electronic Ignition	0	0	0	0	0	-	0	0	S	0	0	S	S	S	S	S	S	S	0	0	S	-

*Antique brass not available for the GD/BGD33/34 or GD70 **Painted black finish available only † Porcelain enamel Majolica brown finish available only ° Available for FC units only

GD19 - The Vittoria™

Shown on pages 4 & 5

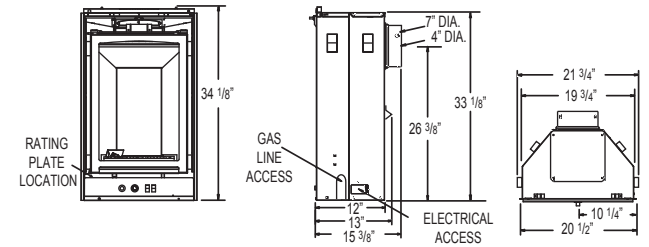

Model	BTU's (Input)		Venting	Height		Front Width		Depth		Glass Type	Glass Size		Glass Area (sq. in.)	Efficiencies			Blower	Mobile Home Certified	Electronic Ignition
	Natural Gas	Propane		Actual	Framing	Actual	Framing	Actual	Framing		Height	Width		EnerGuide	AFUE	Steady State			
GD19	11,500	11,000	Top/Rear	34 1/8"	34 3/8"	20 1/2"	22 1/4"	13"	13 1/4"	Ceramic	24"	16 5/8"	399	55.9%	-	75%	Optional	Yes	Yes

Certified under Canadian and American National standards: CSA 2.22, ANSI Z21.50 for vented gas fireplaces. This product has a design registration. Wolf Steel Ltd ©

GD33 & BGD33

Shown on pages 6 & 7

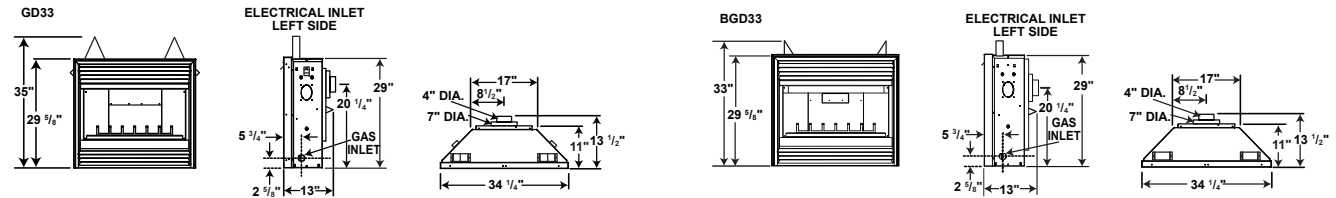

Model	BTU's (Input)		Venting	Height		Front Width		Depth		Glass Type	Glass Size		Glass Area (sq. in.)	Efficiencies			Blower	Mobile Home Certified	Electronic Ignition
	Natural Gas	Propane		Actual	Framing	Actual	Framing	Actual	Framing		Height	Width		EnerGuide	AFUE	Steady State			
GD33	22,000	22,000	Rear	35"	35 1/4"	34 1/4"	34 3/4"	13"	13 1/4"	Ceramic	15 5/8"	30 1/8"	470	64.6%	63%	79.4%	Optional	Yes	Optional
BGD33	15,000	15,000	Rear	33"	33 1/4"	34 1/4"	34 3/4"	13"	13 1/4"	Tempered	15 5/8"	30 1/8"	470	59.1%	-	71%	Optional	Yes	Optional

Certified under Canadian and American National standards: CSA 2.22, ANSI Z21.50 for vented gas fireplaces.

GD34 & BGD34

Shown on pages 6 & 7

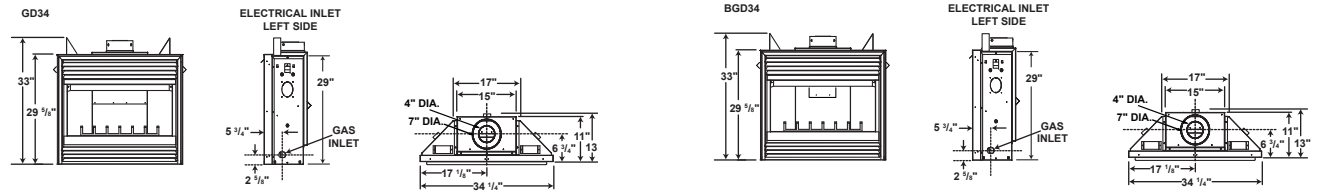

Model	BTU's (Input)		Venting	Height		Front Width		Depth		Glass Type	Glass Size		Glass Area (sq. in.)	Efficiencies			Blower	Mobile Home Certified	Electronic Ignition
	Natural Gas	Propane		Actual	Framing	Actual	Framing	Actual	Framing		Height	Width		EnerGuide	AFUE	Steady State			
GD34	22,000	22,000	Top	33"	33 1/4"	34 1/4"	34 3/4"	13"	13 1/4"	Ceramic	15 5/8"	30 1/8"	470	54%	-	81.3%	Optional	Yes	Optional
BGD34	15,000	15,000	Top	33"	33 1/4"	34 1/4"	34 3/4"	13"	13 1/4"	Tempered	15 5/8"	30 1/8"	470	53.6%	-	78%	Optional	Yes	Optional

Certified under Canadian and American National standards: CSA 2.22, ANSI Z21.50 for vented gas fireplaces. GD34 requires non-combustible material (see installation manual).

Figures may vary with individual conditions such as floor plan layout, insulation value/heat loss of the house and geographical location. Measurements to be used as a guide only. Consult your owner's manual for complete and up-to-date installation instructions and proper clearances to combustible materials.

GD82T-PA - The Park Avenue™

Shown on pages 8 & 9

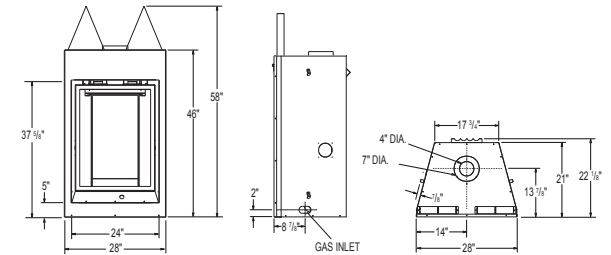

Model	BTU's (Input)		Venting	Height		Front Width		Depth		Glass Type	Glass Size		Glass Area (sq. in.)	Efficiencies			Blower	Mobile Home Certified	Electronic Ignition
	Natural Gas	Propane		Actual	Framing	Actual	Framing	Actual	Framing		Height	Width		EnerGuide	AFUE	Steady State			
GD82T-PA	26,000	26,000	Top	58"	58 1/4"	28"	29"	22 1/8"	22 1/2"	Ceramic	29"	22"	638	54.4%	56%	62%	Included	Yes	No

Certified under Canadian and American National standards: CSA 2.33, ANSI Z21.88 for vented gas fireplace heaters.

GD36 & BGD36 - 36" Fireplaces

Shown on pages 10 & 11

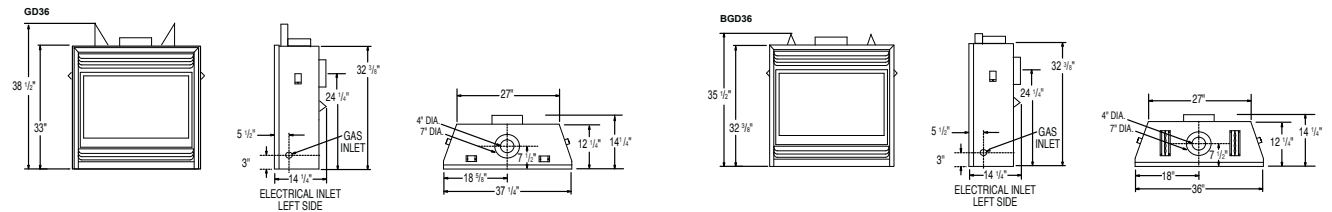

Model	BTU's (Input)		Venting	Height		Front Width		Depth		Glass Type	Glass Size		Glass Area (sq. in.)	Efficiencies			Blower	Mobile Home Certified	Electronic Ignition
	Natural Gas	Propane		Actual	Framing	Actual	Framing	Actual	Framing		Height	Width		EnerGuide	AFUE	Steady State			
GD36	26,000	26,000	Top/Rear	38 1/2"	38 3/4"	37 1/4"	37 3/4"	14 1/4"	14 1/2"	Ceramic	19 3/8"	31 5/8"	613	66.4%	65%	86%	Optional	Yes	Optional
BGD36	18,000	17,000	Top/Rear	35 1/2"	35 3/4"	36"	36 1/2"	14 1/4"	14 1/2"	Tempered	19 3/8"	31 5/8"	613	59.4%	53%	59%	Optional	Yes	Optional

Certified under Canadian and American National standards: CSA 2.33, ANSI Z21.88 for vented gas fireplace heaters.

BGD36CF - Clean Face 36" Fireplaces

Shown on pages 12 & 13

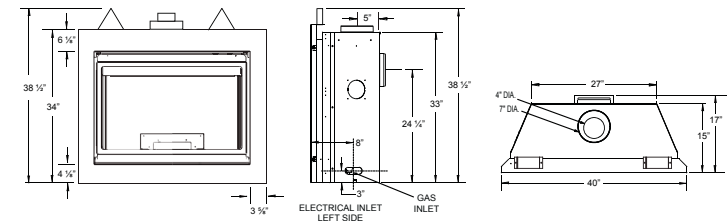

Model	BTU's (Input)		Venting	Height		Front Width		Depth		Glass Type	Glass Size		Glass Area (sq. in.)	Efficiencies			Blower	Mobile Home Certified	Electronic Ignition
	Natural Gas	Propane		Actual	Framing	Actual	Framing	Actual	Framing		Height	Width		EnerGuide	AFUE	Steady State			
BGD36CF	17,000	17,000	Top/Rear	38 1/2"	38 3/4"	40"	40 1/2"	17"	17 1/4"	Tempered	19"	31 1/4"	594	59.4%	53%	64%	Optional	Yes	Optional

Certified under Canadian and American National standards: CSA 2.22, ANSI Z21.50 for vented gas fireplaces.

Figures may vary with individual conditions such as floor plan layout, insulation value/heat loss of the house and geographical location. Measurements to be used as a guide only. Consult your owner's manual for complete and up-to-date installation instructions and proper clearances to combustible materials.

BGD42 & BGD42CF - 42" Fireplaces

Shown on pages 14 & 15

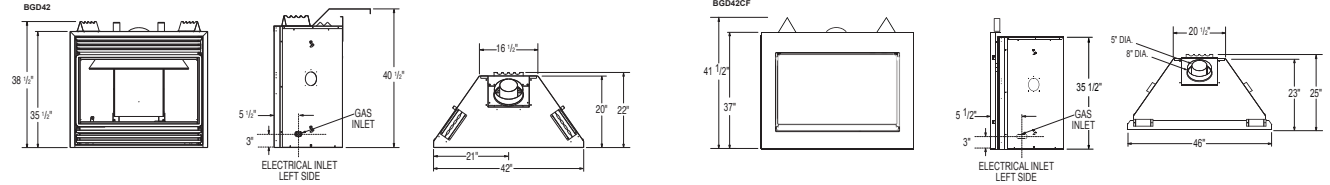

Model	BTU's (Input)		Venting	Height		Front Width		Depth		Glass Type	Glass Size		Glass Area (sq. in.)	Efficiencies			Blower	Mobile Home Certified	Electronic Ignition
	Natural Gas	Propane		Actual	Framing	Actual	Framing	Actual	Framing		Height	Width		EnerGuide	AFUE	Steady State			
BGD42	28,500	24,000	45°	38 1/2"	38 3/4"	42"	42 1/2"	22"	22 1/4"	Tempered	22"	38 5/8"	850	57.6%	-	69%	Optional	Yes	Optional
BGD42CF	24,000	24,000	45°	41 1/2"	41 3/4"	46"	46 1/2"	25"	25 1/4"	Tempered	21 1/4"	37 3/4"	802	54.2%	-	67%	Optional	Yes	Optional

BGD42 Certified under Canadian and American National standards: CSA 2.33, ANSI Z21.88 for vented gas fireplace heaters. BGD42CF Certified under Canadian and American National standards: CSA 2.22, ANSI Z21.50 for vented gas fireplaces.

HD35 - High Definition

Shown on pages 16 & 17

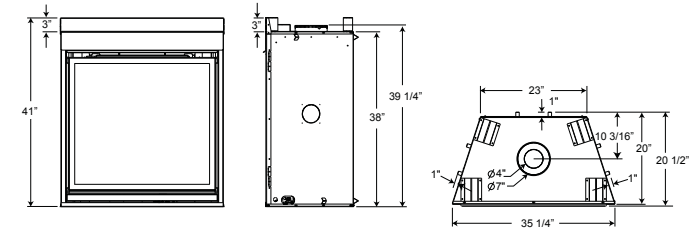

Model	BTU's (Input)		Venting	Height		Front Width		Depth		Glass Type	Glass Size		Glass Area (sq. in.)	Efficiencies			Blower	Mobile Home Certified	Electronic Ignition
	Natural Gas	Propane		Actual	Framing	Actual	Framing	Actual	Framing		Height	Width		EnerGuide	AFUE	Steady State			
HD35	25,000	25,000	Top	41"	41 1/4"	35 1/4"	35 3/4"	20 1/2"	20 1/4"	Tempered	28 1/8"	31 1/4"	879	63.3%	64.4%	82.1%	Optional	Yes	Yes

Certified under Canadian and American National standards: CSA 2.33, ANSI Z21.88 for vented gas fireplace heaters.

HD40 - High Definition

Shown on pages 16 & 17

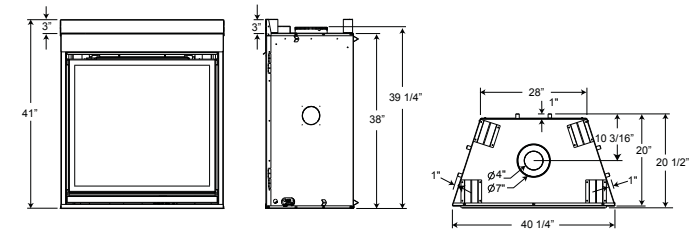

Model	BTU's (Input)		Venting	Height		Front Width		Depth		Glass Type	Glass Size		Glass Area (sq. in.)	Efficiencies			Blower	Mobile Home Certified	Electronic Ignition
	Natural Gas	Propane		Actual	Framing	Actual	Framing	Actual	Framing		Height	Width		EnerGuide	AFUE	Steady State			
HD40	27,000	27,000	Top	41"	41 1/4"	40 1/4"	40 3/4"	20 1/2"	20 1/4"	Tempered	28"	36"	1008	64.3%	65.6%	76.3%	Optional	Yes	Yes

Certified under Canadian and American National standards: CSA 2.33, ANSI Z21.88 for vented gas fireplace heaters.

Figures may vary with individual conditions such as floor plan layout, insulation value/heat loss of the house and geographical location. Measurements to be used as a guide only. Consult your owner's manual for complete and up-to-date installation instructions and proper clearances to combustible materials.

HD46 - High Definition

Shown on pages 16 & 17

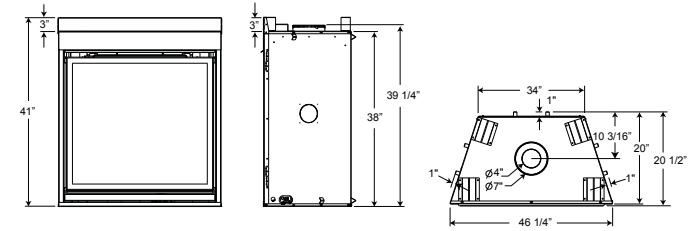

Model	BTU's (Input)		Venting	Height		Front Width		Depth		Glass Type	Glass Size		Glass Area (sq. in.)	Efficiencies			Blower	Mobile Home Certified	Electronic Ignition
	Natural Gas	Propane		Actual	Framing	Actual	Framing	Actual	Framing		Height	Width		EnerGuide	AFUE	Steady State			
HD46	30,000	30,000	Top	41"	41 1/4"	46 1/4"	46 3/4"	20 1/2"	20 1/4"	Tempered	28"	42"	1176	65.1%	67.7%	79.2%	Optional	Yes	Yes

Certified under Canadian and American National standards: CSA 2.33, ANSI Z21.88 for vented gas fireplace heaters.

HDX40 - Deluxe High Definition

Shown on pages 18 & 19

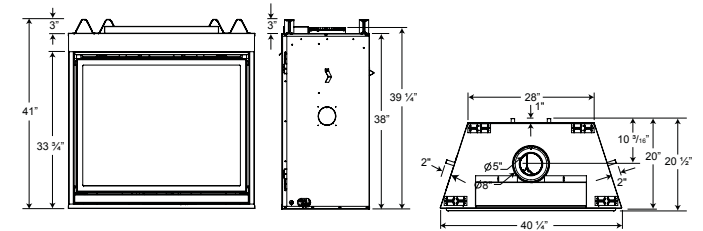

Model	BTU's (Input)		Venting	Height		Front Width		Depth		Glass Type	Glass Size		Glass Area (sq. in.)	Efficiencies			Blower	Mobile Home Certified	Electronic Ignition
	Natural Gas	Propane		Actual	Framing	Actual	Framing	Actual	Framing		Height	Width		EnerGuide	AFUE	Steady State			
HDX40	40,000	36,000	Top	41"	41 1/4"	40 1/4"	40 3/4"	20 1/2"	20 1/4"	Ceramic	28"	36"	1008	56.6%	59.5%	61.5%	Optional	Yes	Yes

Certified under Canadian and American National standards: CSA 2.33, ANSI Z21.88 for vented gas fireplace heaters.

BGD40 - Corner Models

Shown on pages 20 & 21

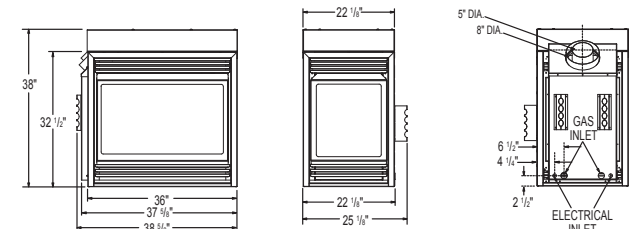

Model	BTU's (Input)		Venting	Height		Front Width		Depth		Glass Type	Glass Size			Glass Area (sq. in.)	Efficiencies			Blower	Mobile Home Certified
	Natural Gas	Propane		Actual	Framing	Actual	Framing	Actual	Framing		Height	Width (End)	Width (Face)		EnerGuide	AFUE	Steady State		
BGD40 Corner Model	30,000	30,000	45°	38"	38 1/4"	37 5/8"	38 5/8"	25 1/8"	25 1/8"	Tempered	19 3/8"	17 1/8"	31 5/8"	946	66.8%	-	68%	Optional	Yes

Certified under Canadian and American National standards: CSA 2.22, ANSI Z21.50 for vented gas fireplaces.

Figures may vary with individual conditions such as floor plan layout, insulation value/heat loss of the house and geographical location. Measurements to be used as a guide only. Consult your owner's manual for complete and up-to-date installation instructions and proper clearances to combustible materials.

HD4 - Multi-View Series

Shown on pages 22 & 23

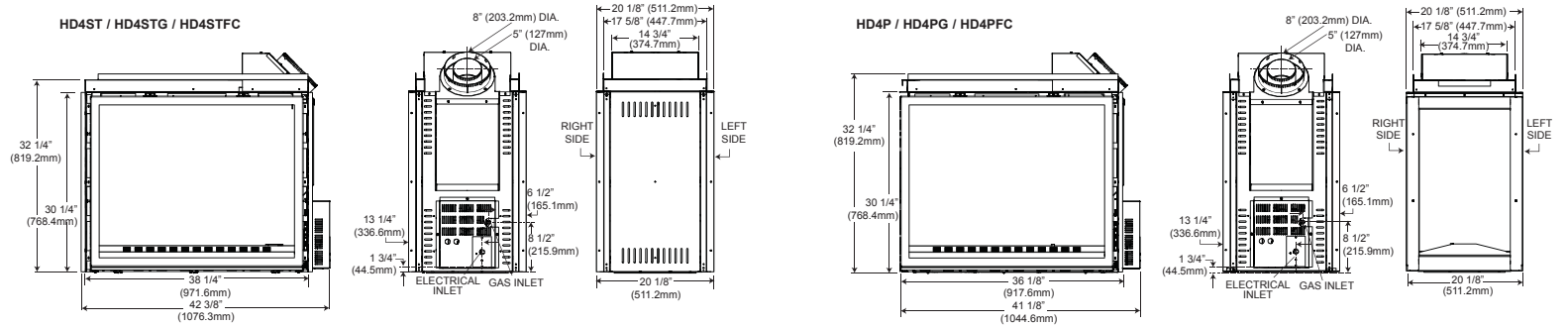

Model	BTU's (Input)		Venting	Height		Front Width		Depth		Glass Type	Glass Size				Glass Area (sq. in.)	Efficiencies			Blower	Mobile Home Certified
	Natural Gas	Propane		Actual	Framing	Actual	Framing	Actual	Framing		Height (End)	Height (Face)	Width (End)	Width (Face)		EnerGuide	AFUE	Steady State		
HD4ST	30,000	30,000	Top/Rear	32 1/4"	42 1/2"	38 1/4"	40 3/4"	20 1/8"	17 5/8"	Tempered	N/A	28 1/2"	N/A	35 1/2"	2024	67.9%	66.98%	69.3%	No	Yes
HD4STG	30,000	30,000	Top/Rear	32 1/4"	42 1/2"	38 1/4"	40 3/4"	20 1/8"	17 5/8"	Tempered	N/A	28 1/2"	N/A	35 1/2"	2024	67.9%	66.98%	69.3%	No	Yes
HD4P	30,000	30,000	Top/Rear	32 1/4"	42 1/2"	37 3/8"	38 3/8"	20 1/8"	17 5/8"	Tempered	27 1/8"	28 1/2"	17"	35 1/2"	2485	67.9%	66.98%	69.3%	No	Yes
HD4PG	30,000	30,000	Top/Rear	32 1/4"	42 1/2"	37 3/8"	38 3/8"	20 1/8"	17 5/8"	Tempered	27 1/8"	28 1/2"	17"	35 1/2"	2485	67.9%	66.98%	69.3%	No	Yes
HD4STFC	30,000	30,000	Top/Rear	32 1/4"	42 1/2"	38 1/4"	40 3/4"	20 1/8"	17 5/8"	Tempered	N/A	28 1/2"	N/A	35 1/2"	2024	67.9%	66.98%	69.3%	No	Yes
HD4PFC	30,000	30,000	Top/Rear	32 1/4"	42 1/2"	37 3/8"	38 3/8"	20 1/8"	17 5/8"	Tempered	27 1/8"	28 1/2"	17"	35 1/2"	2485	67.9%	66.98%	69.3%	No	Yes

Certified under Canadian and American National standards: CSA 2.22, ANSI Z21.50 for vented gas fireplaces.

GD70 - The STARfire™

Shown on pages 24 & 25

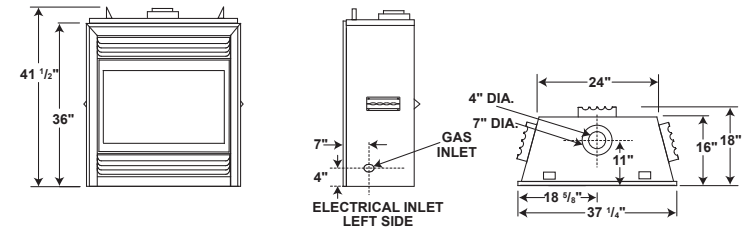

Model	BTU's (Input)		Venting	Height		Front Width		Depth		Glass Type	Glass Size		Glass Area (sq. in.)	Efficiencies			Blower	Mobile Home Certified	Electronic Ignition
	Natural Gas	Propane		Actual	Framing	Actual	Framing	Actual	Framing		Height	Width		EnerGuide	AFUE	Steady State			
GD70	35,000	33,000	Top	41 1/2"	41 3/4"	37 1/4"	37 3/4"	18"	18 1/4"	Ceramic	23"	31 5/8"	727	53.6%	65%	81%	Standard	Yes	Optional

Certified under Canadian and American National standards: CSA 2.33, ANSI Z21.88 for vented gas fireplace heaters.

Figures may vary with individual conditions such as floor plan layout, insulation value/heat loss of the house and geographical location. Measurements to be used as a guide only. Consult your owner's manual for complete and up-to-date installation instructions and proper clearances to combustible materials.

GD80 - The Madison™

Shown on pages 26 & 27

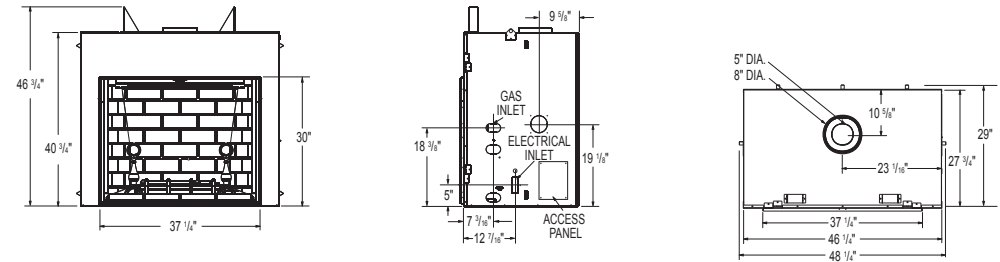

Model	BTU's (Input)		Venting	Height		Front Width		Depth		Glass Type	Glass Size		Glass Area (sq. in.)	Efficiencies			Blower	Mobile Home Certified	Electronic Ignition
	Natural Gas	Propane		Actual	Framing	Actual	Framing	Actual	Framing		Height	Width		EnerGuide	AFUE	Steady State			
GD80	43,000	43,000	Top	46 3/4"	47"	48 1/4"	48 3/4"	29"	29 1/4"	Ceramic	30"	37"	1110	51.4%	-	78%	Standard	Yes	Yes

Certified under Canadian and American National standards: CSA 2.22, ANSI Z21.50 for vented gas fireplaces.

HD81 - See Thru

Shown on pages 28 & 29

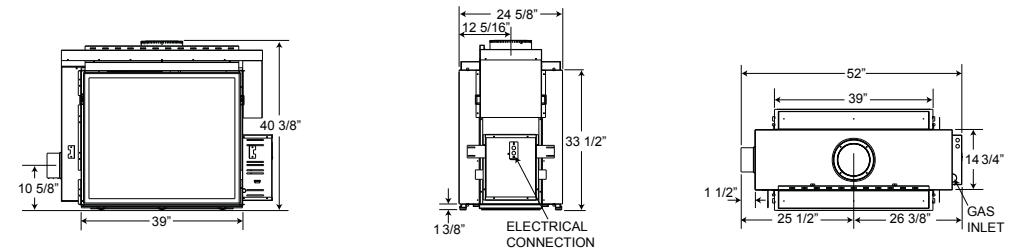

Model	BTU's (Input)		Venting	Height		Front Width		Depth		Glass Type	Glass Size		Glass Area (sq. in.)	Efficiencies			Blower	Mobile Home Certified	Electronic Ignition
	Natural Gas	Propane		Actual	Framing	Actual	Framing	Actual	Framing		Height	Width		EnerGuide	AFUE	Steady State			
HD81	60,000	50,000	Top	40 3/8"	49 1/4"	52"	54 3/4"	24 5/8"	23 5/8"	Ceramic	30 3/4"	36 3/4"	2260	65%	68%	67%	Optional	Yes	Yes

Certified under Canadian and American National standards: CSA 2.33, ANSI Z21.88 for vented gas fireplace heaters.

BGD90 - The Dream™

Shown on pages 30 & 31

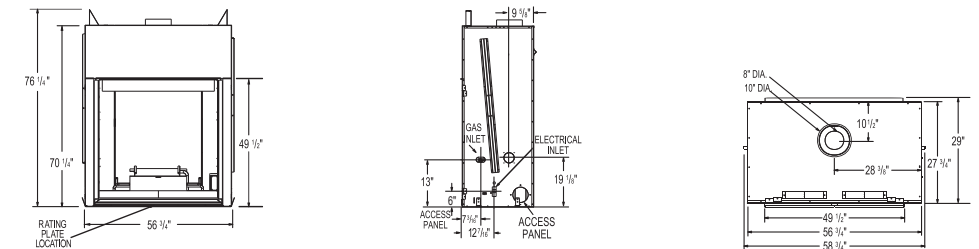

Model	BTU's (Input)		Venting	Height		Front Width		Depth		Glass Type	Glass Size		Glass Area (sq. in.)	Efficiencies			Blower	Mobile Home Certified	Electronic Ignition
	Natural Gas	Propane		Actual	Framing	Actual	Framing	Actual	Framing		Height	Width		EnerGuide	AFUE	Steady State			
BGD90	50,000	50,000	Top	76 1/4"	76 1/2"	58 3/4"	59 1/4"	29"	29 1/2"	Tempered	49 1/2"	49 1/2"	2450	63%	54%	63%	Optional	Yes	No

Certified under Canadian and American National standards: CSA 2.22, ANSI Z21.50 for vented gas fireplaces.

Figures may vary with individual conditions such as floor plan layout, insulation value/heat loss of the house and geographical location. Measurements to be used as a guide only. Consult your owner's manual for complete and up-to-date installation instructions and proper clearances to combustible materials.

Other Napoleon Products



Fireplace Inserts • Charcoal Grills • Gas Fireplaces • Waterfalls • Wood Stoves
 Hybrid Furnaces • Electric Fireplaces • Heating & Cooling • Gourmet Grills



24 Napoleon Road, Barrie, Ontario, Canada L4M 0G8
 103 Miller Drive, Crittenden, Kentucky, USA 41030
 7200 Trans Canada Highway, Montreal, Quebec, Canada H4T 1A3

Tel: 705-721-1212 Fax: 705-722-6031
napoleonfireplaces.com

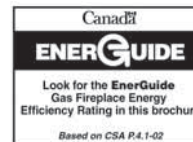

Authorized Dealer

Consult your owner's manual for complete installation instructions and proper clearances to combustible materials. Check all local and national building codes and gas regulations. All specifications are subject to change without prior notice due to on-going product improvements. Products may not be exactly as shown. Flame height and activity is influenced by varying vent configurations and may not appear as shown. Napoleon is a registered trademark of Wolf Steel Ltd. © Wolf Steel Ltd. EnerGuide - A Canadian efficiency standard based on frequent, short start-up and cool-down cycles. All appliances sold in Canada are subject to this EnerGuide rating system. AFUE - A US efficiency standard (Department of Energy) based on extended on/off cycles, more typical of fireplace usage. Steady State - Reflects the highest possible overall heating efficiency.