



Majestic Direct Vent Gas Fireplace Shopping Guide

PREMIUM DESIGN. STUNNING STYLE.





ADD STYLE TO ANY ROOM. Majestic direct vent gas fireplaces are available in a variety of designs, from specialty and contemporary options to more traditional. Discover all your options and find the right Majestic fireplace for you.

Echelon shown with Black Porcelain Panels. (pg.10)
On Cover: Marquis with Old English Firebrick (pg.8)

ALL OUR MAJESTIC DIRECT VENT GAS FIREPLACES OFFER GREAT FEATURES INCLUDING

WIDE VIEWING AREAS

Designed to deliver a beautiful flame picture, all of our fireplaces provide an expansive view of the fire that will delight friends and family.

WARMTH AND COMFORT

No matter which style you choose, you can depend on Majestic fireplaces to deliver ample BTUs to help heat your home for years to come.

EXCLUSIVE SIGNATURE COMMAND™ SYSTEM

Enjoy the ultimate in fireplace control, featuring a touch screen remote* and 3-step flame height adjustment. With electronic ignition, this system lights the pilot only when you turn it on to help save energy.

And, with automatic battery back-up, you can be assured of fireplace operation even if the power goes out.

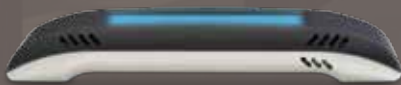

Look for Total Signature Command™ on select models, featuring the exclusive Smart Mode® thermostat for enhanced energy efficiency, rear burner shut down and more!

Learn more about Signature Command™ options on the back cover.

*Available with select fireplaces. Signature Command™ not available with the Lexington Fireplace.

DVBH SERIES SUPERIOR EFFICIENCY

With a CSA rating of 85%, this fireplace provides an efficient source of heat for almost any room. A host of design options allow you to personalize the look of your fireplace.



DVBH shown with Cottage Red Firebrick

DVBH QUICK LOOK

Sizes	33", 36"
Heating Capacity	1,000 – 1,200 sq. ft.
Max BTUs	16,000 – 27,000
Thermal Efficiency	Up to 85%
Control System	Signature Command™



ADDITIONAL FEATURES

- Ceramic Glass
- Deluxe Illustrated Control Panel
- Mesh Glass Cover also available

DESIGN OPTIONS

Finishing

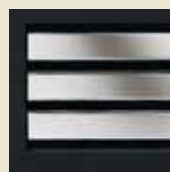

Stainless Steel Louvers



Black and Stainless Trim available in Medium (shown) and Curved styles



Interior Firebrick



Cottage Red



Tavern Brown

CAMEO

CREATE A CENTERPIECE OF CLASSIC STYLE

With a range of more traditional design options, like louvers, arched fronts and doors, you can achieve a classic look that becomes a centerpiece for your home. Plus, the large format provides a wide viewing area that showcases the dancing flames from anywhere in the room.



Cameo shown with Tavern Brown Firebrick

DESIGN OPTIONS

Interior Firebrick



Cottage Red (standard)



Tavern Brown

CAMEO QUICK LOOK

Sizes	42", 47"
Heating Capacity	1,500 – 1,600 sq. ft.
Max BTUs	21,500 – 32,000
Thermal Efficiency	Up to 80%
Control System	Signature Command™



FINISHING OPTIONS

Available in Black Texture and Iron Age



- Classic Arched Front

- Cabinet Door Frame

- Cabinet Door with Screen

Filigree Panels and Mesh Glass Cover also available (not pictured)



Black and Stainless trim available in Medium (shown) and Curved styles

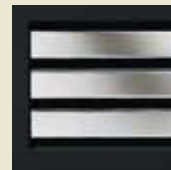

Stainless Steel Louvers



ONYX

OPEN VIEW. MODERN STYLING.

The clean face design of this fireplace provides sleek styling with an air of modern sophistication plus a wide viewing area. Complete with a robust, premium log set, the Onyx is a stunning addition to your home.

Onyx shown with Olde English Firebrick

DESIGN OPTIONS

Interior Firebrick



Cottage Red



Tavern Brown



Olde English

- Mesh Glass Cover also available (not pictured)

ONYX QUICK LOOK

Sizes	42"
Heating Capacity	1,500 – 1,660 sq. ft.
Max BTUs	22,000 – 34,000
Thermal Efficiency	Up to 80%
Control System	Signature Command™





Lexington shown with Nantucket Rectangular Front in Textured Black

LEXINGTON QUICK LOOK

Sizes	32", 36"
Heating Capacity	1,520 – 1,950 sq. ft.
Max BTUs	22,000 – 44,000
Thermal Efficiency	Up to 80%
Control System	Millivolt Control

ADDITIONAL FEATURES

- Heat Activated Blower Standard
- Remote Ready
- Variable Flame Control
- Ceramic Glass with Quick Release Latch
- Deluxe Control Panel
- LexFire Burn System™
- Built-in Adjustable Flue Restrictor
- High Altitude Kit optional

DESIGN OPTIONS

Nantucket Rectangular Fronts

Black*



Textured Black



Vintage Iron



Nantucket Arched Fronts

Black*



Textured Black



Vintage Iron with Fire Screen Doors



Lexington Arched Fronts (also available in black)

Textured Black

Fire Screen Doors in Vintage Iron



Vintage Iron

Fire Screen Doors in Vintage Iron



*Not available with doors.

EXCLUSIVE LEXFIRE BURN SYSTEM™

So realistic, you'll forget it's not real wood.

Featuring:

- Glowing, hand-carved logs
- Bright yellow flames
- Realistic ember bed
- Unparalleled flame pattern and realism {the hallmark of the LexFire Burn System™}
- Precise combustion and airflow

Visit majesticproducts.com to learn more about the LexFire Burn System™!

LEXINGTON

IMPRESSIVE REALISM

Enjoy the most realistic gas fire available, thanks to the exclusive LexFire Burn System.™ Featuring varying flame height and glowing logs, it mimics the natural progression of a wood burning fire for a truly authentic presentation. Plus, the Lexington Series offers unique finishing options to complete your look.



Lexington shown with Lexington Arched Front in Textured Black with Vintage Iron Fire Screen Doors

MARQUIS

CRYSTAL-CLEAR VIEW

This fireplace's clean face design and wide-open flame presentation is an impressive addition to any room. Non-reflective ClearView ceramic glass provides an unobstructed view of the fire's glow from any angle, while the included accent light complements the beautiful design. In addition, rear burner shut off reduces BTUs, so you can enjoy the beauty of the fire without as much heat on milder evenings.



Marquis shown with Olde English Firebrick and Accent Light



Marquis shown with Tavern Brown Firebrick and Decorative Black Texture Arched Door

QUICK LOOK

MARQUIS

MARQUIS SEE-THRU

Sizes	44", 48", 60"	48"
Heating Capacity	1,800 – 3,100 sq. ft.	2,700 – 2,780
Max BTUs	28,500 – 60,000	28,500 – 56,000
Thermal Efficiency	Up to 85%	Up to 80%
Control System	Total Signature Command™ also available in Millivolt Control	Total Signature Command™



Note: Millivolt units have a manual control dimmer for the accent light.

MARQUIS SEE-THRU

TWO ROOMS, ONE FIREPLACE

This specialty option gives you the ability to enjoy the beautiful, clean-face design of the Marquis fireplace from two rooms at once. Two non-reflective ceramic glass sides provide a "pass-through" effect, while the ability to install on an exterior wall allows you to add a dramatic effect to both indoor and outdoor settings. For ambiance without as much heat, use the center burner shut off to reduce BTUs.

specialty ◇ model

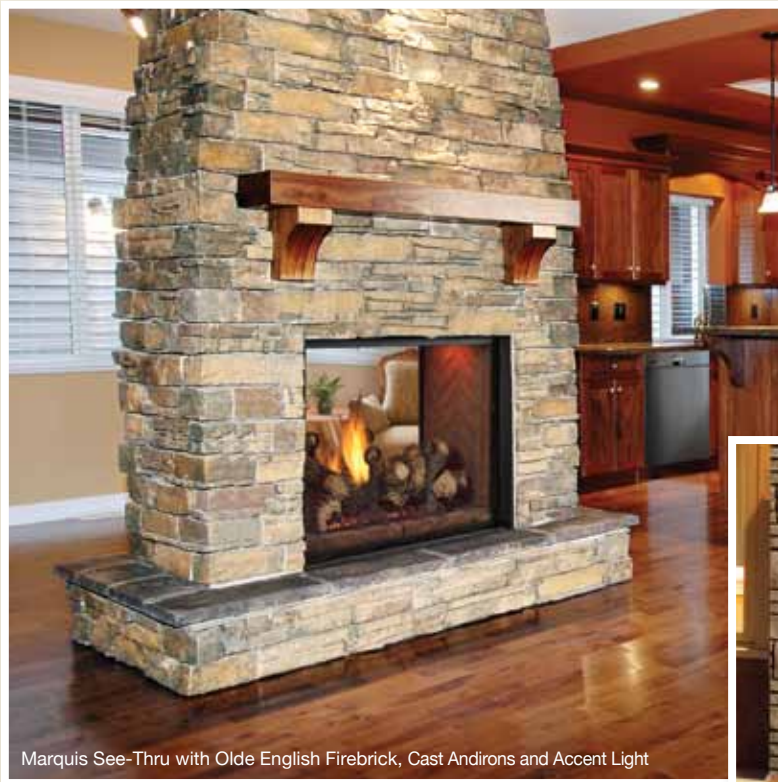

Marquis See-Thru with Olde English Firebrick, Cast Andirons and Accent Light

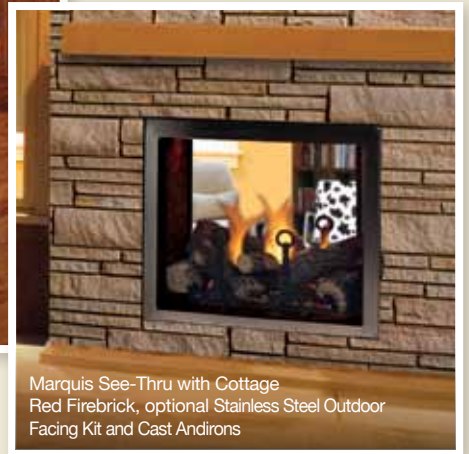

Marquis See-Thru with Cottage Red Firebrick, optional Stainless Steel Outdoor Facing Kit and Cast Andirons



Forged Andirons (13")



Cast Andirons (12")



Cast Andirons (16") -
Marquis KHLDV600 (60")
models only

Interior Firebrick



Cottage Red



Tavern Brown



Olde English

Pearl Corner shown with Porcelain Panels and Contemporary Stone and Glass



Pearl Peninsula shown with Log Set, Cottage Red Firebrick, Barrington Dark Walnut Cabinet and optional Accent Light



Note: Cabinet available for Peninsula model only. See Cabinet dimensions on page 15.

PEARL QUICK LOOK

Sizes	See-Thru, Corner, Peninsula
Heating Capacity	1,450 – 1,780 sq. ft.
Max BTUs	25,000 – 37,000
Thermal Efficiency	Up to 80%
Control System	Signature Command™



DESIGN OPTIONS

Interior Firebrick



Cottage Red



Olde English

- Black Porcelain Liner and Accent Light also available. (not pictured)



PEARL DESIGNER SERIES

STUNNING FROM ANY ANGLE

With three different configuration options – See-Thru, Corner and Peninsula – the Pearl Designer Series adds a dramatic accent to any room, no matter how you look at it. Each style provides an expansive view of the fire from multiple sides, while interior options like contemporary glass, stone and light kits transform your fireplace into a statement piece, even when it isn't lit.

specialty ◇ model

Pearl See-Thru shown with Log Set, Cottage Red Firebrick and optional Light Kit

Fireglass

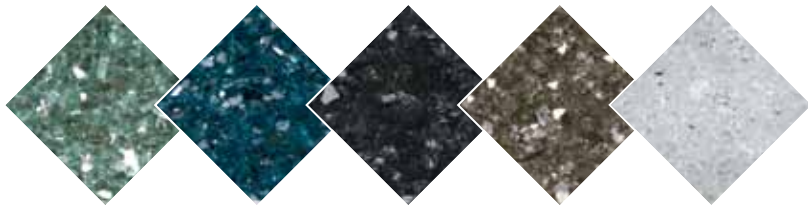

Emerald Sapphire Onyx Bronze Diamond



Contemporary Stone with Bronze Glass Ember Bed

Note: Glass kits include one 2.25 lb. bag. Designer units require two bags.

ECHELON

THE LATEST IN CONTEMPORARY DESIGN

Offering the very latest in contemporary styling, the Echelon is truly a designer fireplace, featuring a linear format and beautiful ribbon flame. Accented with unique finishing options like our gorgeous Stainless Steel Surround, this fireplace is truly a work of art. And with our Glass Illumination Light System, the Echelon is eye-catching even when it isn't lit.



Echelon shown with Contemporary Stainless Steel Surround and optional Aged Driftwood Log Set



ECHELON SEE-THRU

UNPARALLELED LUXURY

Combining the Echelon fireplace's contemporary, wide-open style with the dynamic look of a see-thru fireplace, this is the ultimate in luxury design. Plus, it can be installed between two interior rooms or on an exterior wall, making it the only linear fireplace on the market to offer this versatile installation feature.

specialty ◇ model



Echelon See-Thru shown with Outdoor Facing Kit

DESIGN OPTIONS FOR ECHELON AND ECHELON SEE-THRU

Finishing	42" WDV500	60" WDV600	SEE-THRU 42" WDVST500
Black Trim	Available	Available	Available
Stone Studio	Available	-	Available
Stainless	Available	Available	Available
Textured Black	Available	Available	Available
Iron Age	Available	Available	Available
Outdoor Stainless Steel Trim	-	-	Available for installation on exterior wall
Porcelain Panels	Optional	Standard	Standard
Stone and Glass Kit	Standard	Standard	Standard
Aged Driftwood Log Set	Optional	Optional	Optional
Quick Latch System	Yes, Ceramic Glass	Yes, Anti-Reflective Glass	Yes, Ceramic Glass



Echelon shown with Textured Black Surround and Contemporary Stone Kit - Also available in Iron Age



Echelon shown with Black Trim Kit

Fireglass

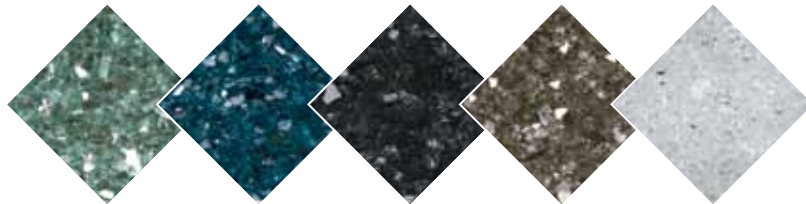

Emerald

Sapphire

Onyx

Bronze

Diamond

Note: Fireglass kits include one 2.25 lb. bag. WDV500 and WDVST500 require 2 bags. WDV600 requires 3 bags.



Contemporary Stone shown with Bronze Glass Ember Bed



Aged Driftwood Log Set

QUICK LOOK

ECHELON

ECHELON SEE-THRU

Sizes	42", 60"	42"
Heating Capacity	1,400 – 2,000 sq. ft.	1,300 – 1,330 sq. ft.
Max BTUs	23,000 – 45,000	27,500 – 34,000
Thermal Efficiency	Up to 80%	Up to 80%
Control System	Total Signature Command™	Total Signature Command™



Echelon See-Through with Studio Stone Surround and Contemporary Stone Kit

MAJESTIC DIRECT VENT SYSTEMS LINEUP

MODEL	DVBH		CAMEO		ONYX	LEXINGTON	
Sizes	33"	36"	42"	47"	42"	32"	36"
Model #s	300DVBH	400DVBH	500DVM	600DVM	MLDV500	LX32	LX36
Standout Feature	AFUE-rated fireplace for superior efficiency		Wide viewing area and multiple finishing options		Clean face design and premium log set	Exclusive LexFire Burn System™	
Operating System	Signature Command™		Signature Command™		Signature Command™	Millivolt Control	
Max heating capacity (sq ft)	1,100	1,200	1,500	1,600	1,660	1,520	1,950
Viewing style	Front		Front		Front, Clean Face	Front	
Maximum viewing area (sq in)	538	652	764	903	922	762	810
Max BTU/hr*	23,000	27,000	30,000	32,000	34,000	36,000	44,000
Thermal efficiency	Up to 85%	Up to 85%	Up to 80%	Up to 80%	Up to 80%	Up to 80%	Up to 80%
Burner system	Natural Flame		Natural Flame		Natural Flame	LexFire Burn System™	
AFUE Efficiency	Up to 65%	Up to 66%	Up to 64%	N/A	N/A	N/A	N/A
FE Ratings (Canada)	67.4% NG 75.7% LP	70.9% NG 74% LP	Up to 82%	Up to 74%	Up to 76%	66.1% NG 66.2% LP	66.8% NG 69.1% LP
Dimensions (Actual)	33 1/16" W 37 7/8" H 15" D	37 1/16" W 41 1/2" H 18 1/4" D	41" W 40 3/8" H 20 3/4" D	47" W 40 3/8" H 20 3/4" D	41" W 50 3/4" H 22 1/4" D	39" W 46 1/2" H 21 3/4" D	43" W 46 1/2" H 21 3/4" D
Dimensions (Framing)	33 1/2" W 38" H 13 3/4" D	37 1/2" W 41 5/8" H 16 1/2" D	42" W 46 1/2" H 20 3/8" D	48 1/16" W 46 1/2" H 20 3/8" D	42 1/2" W 50 7/8" H 22 1/4" D	41 11/16" W 47 5/8" H 21 3/4" D	45 11/16" W 47 5/8" H 21 3/4" D

ACCESSORIES

Remotes	Optional	Optional	Optional	Thermostat Controls Optional
Blower Kits	Optional	Optional	Optional	Standard
Field Fuel Conversion Kit	Available	Available	Available	Available

Gold indicates upgrade from previous model.

*For natural gas models.

All Majestic Direct Vent Fireplaces in this catalog are CSA Design Certified and available in both natural gas and LP configurations.

REMOTES AND THERMOSTATS ARE AVAILABLE FOR ALL MODELS FOR ADDED CONVENIENCE.



Touch screen hand held ON/OFF remote. A touch screen remote comes standard with Total Signature Command™ models.



Thermostat ON/OFF remote control with 3-step flame height adjustment and 3-step blower control with receiver



Programmable wireless wall thermostat with receiver

MARQUIS			MARQUIS SEE-THRU	PEARL	ECHELON		ECHELON SEE-THRU
44"	48"	60"	48"	36" Specialty	42"	60"	42"
KHLDV400	KHLDV500	KHLDV600	KSTDV500	STLDV, PFLDV, CLLDV, CRLDV	WDV500	WDV600	WDVST500
Non-reflective, ClearView ceramic glass			Specialty design lets you view the fire from two rooms at once	3 different configurations for versatile style and installation options	Ultra-contemporary wide view design and the latest technology		The first linear fireplace on the market that can be installed on an exterior wall for an indoor-outdoor view
Total Signature Command™ or Millivolt Control		Total Signature Command™	Total Signature Command™	Signature Command™	Total Signature Command™		Total Signature Command™
2,100	2,500	3,100	2,780	1,780	1,430	2,000	1,330
Front, Clean Face			See-Thru	See-Thru, Corner, Peninsula	Front, Clean Face		See-Thru
960	1,080	1,500	2,160	2,771	497	648	990
40,000	50,000	60,000	56,000	37,000	34,000	45,000	34,000
Up to 80%	Up to 80%	Up to 85%	Up to 80%	Up to 80%	Up to 80%	Up to 80%	Up to 80%
-	-	-	-	-	-	-	-
N/A	N/A	66% NG 66% LP	67.4% NG 66.3% LP	67.01% NG 68.28% LP	N/A	65.9% NG 66.1% LP	Up to 80%
Up to 82%	Up to 78%	81.0% NG 80.0% LP	77.3% NG 74.3% LP	69.7% NG 79.4% LP	64.4% NG 67.7% LP	70.2% NG 72.2% LP	61.0% NG 59.7% LP
44 15/16" W 44 3/8" H 23 7/8" D	48 15/16" W 44 3/8" H 23 7/8" D	55" W 50 15/16" H 24 1/4" D	49 1/2" W 44 1/2" H 24" D	See Thru: 49 9/16" W x 47 7/8" H x 24" D Corner: 46 3/8" W x 47 7/8" H x 24" D Peninsula: 46 3/8" W x 47 7/8" H x 24" D	46 1/8" W 35 7/16" H 18 3/16" D	57 1/8" W 35 7/16" H 18 15/16" D	51 1/4" W 38 3/8" H 17 3/8" D
45 5/16" W 44 3/4" H 23 7/8" D	49 5/16" W 44 3/4" H 23 7/8" D	55 1/2" W 50 9/16" H 24 1/2" D	50" W 44 3/4" H 23" D	See Thru: 50 1/16" W x 48 3/16" H x 23" D Corner: 46 5/8" W x 48 3/16" H x 27 7/8" D Peninsula: 46 5/8" W x 48 3/16" H x 23" D"	46 5/8" W 35 5/8" H 17 7/8" D	57 5/8" W 35 5/8" H 18 5/8" D	51 3/4" W 38 1/2" H 17 3/8" D
Optional	Optional	Optional	Optional	Optional	Touchscreen remote included		Touchscreen remote included
Optional	Optional	Optional	Optional	Optional	Optional		Optional
Available	Available	Available	Available	Available	Available		Available

BARRINGTON CABINET OPTION FOR PEARL PENINSULA (SGP36)
See Cabinet on page 10.

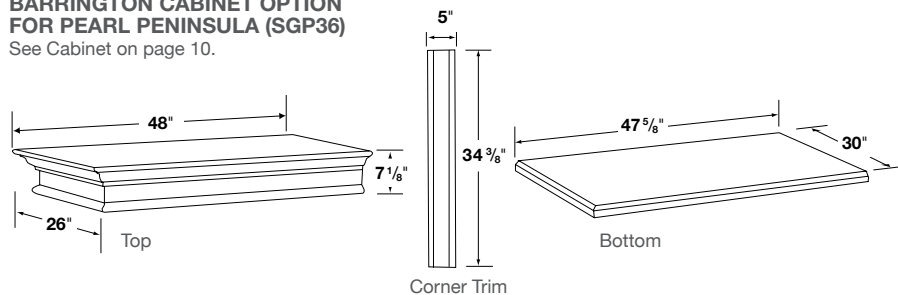

ULTIMATE CONVENIENCE AT YOUR FINGERTIPS

Our direct vent gas fireplaces offer two **Exclusive Signature Command™ Systems**.
Discover the level of control that's right for you!

Signature Command™ System

An A/C adaptor is included; however, unlike competing control systems that require A/C to function, the Signature Command™ system can be installed where no power is available, making it more convenient than ever to enjoy the fire.

Featuring:

- ON/OFF 3-step variable flame height adjustment
- Automatic, uninterrupted battery back-up during power outages
- Pilot selection option — choice of cold climate standing pilot or the energy efficient intermittent pilot
- Memory shut off remembers your favorite setting the next time the fireplace is turned on
- Convenient diagnostic code indication lights
- Built-in remote receiver provides you the ability to easily add a remote control

Total Signature Command™ System

Enjoy the convenience of a technologically advanced and energy efficient fireplace control system!

Featuring:

All of the features included with Signature Command™

PLUS:

- Smart Mode® thermostat for enhanced energy efficiency — it automatically adjusts flame height and/or blower to maintain the desired temperature, using only the energy it needs to help save on fuel costs.
- TSFSC Full Function Touch Screen remote control
- Rear burner shut down feature lowers heat output as much as 70% for ambiance when heat is not needed (on select fireplaces)
- A/C accessory model for added control features, like household lighting, waterfall feature, and more!



YOUR STYLE. YOUR HOME. YOUR LIFE.

A Brand of Monessen Hearth Systems Co.
149 Cleveland Drive, Paris, Kentucky 40361
majesticproducts.com

Your Majestic Dealer:

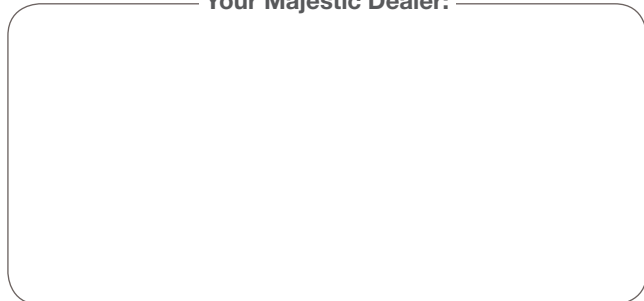

To avoid personal injury or property damage, the product described by this brochure must be installed, operated and maintained in strict compliance with the instructions packaged with the product and all applicable building or fire codes. Contact local building or fire officials about restrictions and installation inspection requirements. All photographs and drawings on this brochure are for illustrative purposes only and are not intended for, nor should they be used as a substitute for the instructions packaged with the unit. Appearance and specifications of the product are subject to change without notice.
©2011 Monessen Hearth Systems Co. 11115_1011

For more information about MHSC and Majestic efficient and environmentally friendly products, please visit majesticproducts.com

1211MAJ Ver.01